



ATLANTIC TESTING LABORATORIES

WBE certified company

Plattsburgh
130 Arizona Avenue
Suite 1540
Plattsburgh, NY 12903
518-563-5878 (T)
atlantictesting.com

March 7, 2024

Essex County Department of Public Works
8053 US Route 9
PO Box 217
Elizabethtown, New York 12932

Attn: Andrew Stanley

Re: Limited Hazardous Materials Survey
Frontier Town Renovations
Schroon Lake, New York
ATL Report No. PL6057CE-01-03-24

Ladies/Gentlemen:

Enclosed is a copy of the Limited Hazardous Materials Survey report prepared for the referenced site. This project was completed in accordance with the scope of work outlined in our contract (ATL No. PL5998-692-11-23), dated November 7, 2023, and authorized by Michael Mascarenas on January 4, 2024.

Please contact our office should you have any questions, or if we may be of further assistance.

Sincerely,
ATLANTIC TESTING LABORATORIES, Limited

Robert B. Read
Project Manager

RBR/JDG/jdf

Enclosures

LIMITED HAZARDOUS MATERIALS SURVEY

**FORMER FRONTIER TOWN RENOVATIONS
SCHROON LAKE, NEW YORK**



WBE certified company

PREPARED BY:

**ATLANTIC TESTING LABORATORIES, LIMITED
130 Arizona Avenue, Suite 1540
Plattsburgh, New York 12903**

PREPARED FOR:

**Essex County Department of Public Works
8053 US Route 9
PO Box 217
Elizabethtown, New York 12932**

ATL REPORT NO. PL6057CE-01-03-24

March 7, 2024

TABLE OF CONTENTS

1.0 INTRODUCTION	1
1.1 Purpose.....	1
1.2 Project Team and Certifications	1
2.0 SCOPE OF WORK	1
2.1 Project Description.....	1
2.2 Inaccessible Areas.....	1
2.3 Document Review.....	2
2.4 Limitations.....	2
3.0 ASBESTOS	2
3.1 Methodology	2
3.2 Regulatory Compliance.....	2
3.3 Summary of Findings	3
4.0 LEAD-BASED PAINT.....	3
4.1 Methodology	3
4.2 Regulatory Compliance.....	4
4.3 Summary of Findings	4
5.0 CONCLUSIONS AND RECOMMENDATIONS	4
5.1 General	5
5.2 Asbestos-Containing Materials	5
5.3 Lead-Based Paint	5

APPENDICES

Licenses and Certifications	A
Sample Location Plans	B
Laboratory Reports and Custody Documentation	C
Summary Tables.....	D
Summary of XRF Results and Calibration Checks	E

1.0 INTRODUCTION

1.1 Purpose

Atlantic Testing Laboratories, Limited (ATL) was retained by Essex County Department of Public Works, to perform a limited hazardous materials survey of designated buildings within the former Frontier Town park. The limited survey was performed on January 29 and 31, 2024. The purpose of the limited hazardous materials survey was to identify asbestos-containing materials (ACM) and lead-based paint (LBP) that are present on exposed surfaces within the subject areas, and may have a significant impact on planned renovation and demolition activities. The limited asbestos or hazardous materials survey procedures and report format that follow are in general compliance with applicable local, state, and federal rules and regulations.

1.2 Project Team and Certifications

Members of the ATL project team included Jeremy D. Fessette, Engineering Assistant; and Robert B. Read, Project Manager. Certifications of ATL's field survey team members and a copy of applicable company licenses maintained by ATL are included in Appendix A.

2.0 SCOPE OF WORK

2.1 Project Description

The project site is located within the former Frontier Town Park at 4010 Blue Ridge Road, Schroon Lake, Essex County, New York.

The intent of the limited hazardous materials survey was to identify suspect ACM and LBP that are located within Building Nos. 2.1, 2.6, 2.7 (Carousel), 3.1 (Chapel), and 5.2 (Gristmill) of the former Frontier Town park and may be impacted during proposed renovation and demolition projects.

The limited hazardous materials survey was conducted for the subject buildings, as directed by Jim Dougan, representing Essex County Department of Public Works. The subject buildings were not occupied at the time of the sampling event.

2.2 Inaccessible Areas

The extent of inaccessible areas is dependent upon the building type, construction materials, history of renovations and repairs, and project scope. Concealed materials may exist in areas that are not readily exposed to view. Although this limited hazardous materials survey was performed to identify ACM and LBP within the subject buildings, potential ACM and/or LBP may have escaped detection that could be encountered during future building demolition and/or renovation activities. Wall, ceiling, floor, roofing, and/or other component systems may contain concealed suspect ACM and/or LBP. If any suspect ACM and/or LBP are encountered during demolition and/or renovation activities, the activities disturbing the suspect ACM and/or LBP must stop and the material must be sampled and laboratory analyzed in accordance with applicable regulations.

Sections of Building No. 2.1 were collapsed and inaccessible at the time of the limited hazardous materials survey event. Suspect ACM not identified and bulk sampled from the non-collapsed sections of the referenced building will be assumed ACM.

2.3 Document Review

No historical asbestos or hazardous materials survey reports or sampling and analysis data were available for review at the time of the limited hazardous materials survey.

2.4 Limitations

This report has been prepared in accordance with the scope of work outlined in ATL's contract (ATL No. PL5998-692-11-23), dated November 7, 2023, and should not be used as abatement specifications or design documents. The findings, conclusions, and recommendations presented in this report are based on the field observations made by representatives of ATL and the information provided by representatives of Essex County Department of Public Works.

Quantities and locations of sampled materials are approximate, and should be verified by the abatement contractor(s) prior to providing actual cost quotations and/or initiating abatement activities. Variations in reported quantities and locations for sampled materials, in addition to the discovery of suspect materials not identified in this report, is possible due to the presence of inaccessible areas, as described in Section 2.2 of this report.

The findings and opinions are relevant to the dates of our site work and should not be relied on to represent conditions at substantially later dates.

3.0 ASBESTOS

3.1 Methodology

A visual examination of the subject buildings was conducted by an Asbestos Building Inspector to identify suspect ACM. Functional spaces were identified to assist while locating suspect ACM. A functional space is defined as a spatially distinct area within a building that contains identifiable populations of building occupants. A functional space may include a room, a group of rooms, or other defined area, and several functional spaces may comprise a single homogeneous sampling area. A homogeneous sampling area is defined as an area that is uniform by color, texture, construction/application, and general appearance. Each identified functional space was visually examined to determine the locations of suspect ACM. These materials were then delineated into homogeneous sampling areas.

Samples of each accessible homogeneous area were collected and placed in clean, labeled containers. The appropriate custody documentation was completed and the suspect ACM samples were submitted to AmeriSci New York (AmeriSci), located in New York, New York. The samples were laboratory analyzed by polarized light microscopy (PLM) and transmission electron microscopy (TEM) methodologies, as applicable. AmeriSci is a New York State Department of Health (NYSDOH) certified laboratory for PLM and TEM analysis under Environmental Laboratory Approval Program (ELAP) No. 11480. AmeriSci is also accredited by the National Institute of Standards and Technology (NIST), under the National Voluntary Laboratory Accreditation Program (NVLAP).

3.2 Regulatory Compliance

In New York State, there are multiple regulatory agencies that have jurisdiction over ACM in buildings. Asbestos survey requirements are primarily regulated or specified by the New York State Department of Labor (NYSDOL), the New York State Department of Health (NYSDOH),

the Occupational Safety and Health Administration (OSHA), and the United States Environmental Protection Agency (EPA).

The NYSDOL established Part 56 of The Official Compilation of Codes, Rules, and Regulations (cited as 12 NYCRR, Part 56) to address the proper identification, handling, removal, and disposal of ACM in buildings. Asbestos survey requirements are specified in Subpart 56-5.1 “Asbestos Survey Requirements for Building/Structure Demolition, Renovation, Remodeling and Repair.” The NYSDOL also works in conjunction with the NYSDOH to establish and maintain asbestos safety training program requirements, and enforce personnel certifications and licensing protocol for asbestos contractors.

The OSHA defines requirements for asbestos surveys and identification of ACM and presumed asbestos-containing materials (PACM) in 29 CFR 1926.1101 (k) “Communication of Hazards.” Under this regulation, OSHA makes reference to conducting inspections according to 1926.1101 (k)(5)(ii)(B) and 1926.1101 (k)(5)(iii) or pursuant to the requirements of the Asbestos Hazard Emergency Response Act (AHERA) 40 CFR Part 763, Subpart E “Asbestos-Containing Materials in Schools.” The AHERA is regulated by the EPA, and applies to primary and secondary schools only; however, the procedures mandated under AHERA are generally considered the industry standards for surveys, as these are typically the most stringent.

3.3 Summary of Findings

A total of 32 homogeneous areas of suspect ACM were identified during the visual examination, from which 63 bulk samples were collected and subsequently submitted to a NYSDOH approved laboratory for analysis. Approximate sample locations are depicted on the Sample Location Plans, contained in Appendix B. A copy of laboratory reports and sample custody documentation are contained in Appendix C. Table D-I contained in Appendix D, provides a summary of the identified suspect ACM and associated analytical results.

The EPA, NYSDOL, and other regulatory agencies define ACM as any material containing greater than 1% of asbestos. Materials listed in bold font in Table D-I of Appendix D were determined or assumed to be ACM.

Materials containing trace asbestos (i.e., less than 1%) are not considered ACM; however, the OSHA recognizes materials that contain trace amounts of asbestos, and requires these materials be handled in accordance with their standard interpretation letter titled “Requirements for demolition operations involving material containing <1% asbestos”, dated August 13, 1999. As shown in Table D-I of Appendix D, 1 material was determined to contain trace amounts of asbestos.

Other materials that were observed, but are not considered suspect ACM, include the following;

• Glass	• Nylon-Coated Wire Jacket
• Wood	• Metal
• Ceramic Tile	• Doors

4.0 LEAD-BASED PAINT

4.1 Methodology

A visual examination of the subject buildings was conducted by a Lead Inspector to identify visible and accessible painted surfaces. The painted surfaces were categorized into

homogeneous areas from which tests could be conducted. Each homogeneous area was tested using a Heuresis Pb200i XRF Analyzer. This equipment provides instantaneous measurements for lead concentration in mg/cm², and displays readings that are positive or negative indications for lead-based paint (LBP). Calibration checks for the XRF equipment were performed in accordance with the manufacturer's recommendations.

4.2 Regulatory Compliance

Although New York State has established Title X, Part 67 of The Official Compilation of Codes, Rules, and Regulations (cited as NYCRR Title X, Part 67) for "Lead Poisoning Prevention and Control," LBP inspections and risk assessments are generally subject to the requirements of federal regulations. The United States Department of Housing and Urban Development (HUD), EPA, and OSHA are the primary federal regulatory agencies responsible for the establishment and enforcement of such regulations. On a state level, the NYSDOH does require laboratories to be certified to perform lead analysis under the ELAP.

The HUD "Guidelines for the Evaluation and Control of Lead-Based Paint Hazards in Housing" include details pertaining to sampling and analysis of suspect LBP, in addition to the identification and control of LBP hazards. The HUD guidelines pertain to federally owned or assisted housing; however, these are commonly referenced and made mandatory by other regulatory agencies. The EPA requirements for LBP activities, specified in 40 CFR Part 745, apply to targeted housing and child-occupied facilities, and are similar to HUD guideline requirements.

The OSHA Construction Standard for Lead (29 CFR 1926.62) applies to employees of an employer who may or will be exposed to occupational levels of lead. OSHA requires employees to maintain, at a minimum, awareness, respiratory protection, and hazard communication training.

4.3 Summary of Findings

A total of 65 locations were tested using the XRF spectrometer. Approximate sample locations are depicted on the Sample Location Plan/Plans, contained in Appendix B. A summary of the XRF results and calibration checks are provided in Appendix E. The XRF results provided in Table E-I of Appendix E represent painted surfaces that were determined to be LBP, per HUD criteria. Table E-II of Appendix E identifies painted surfaces that contain detectable concentrations of lead, but are not considered LBP, as compared to HUD criteria. Painted surfaces that did not contain lead at a concentration above the method detection limits are summarized in Table E-III of Appendix E. Calibration checks for the XRF spectrometer are provided in Table E-IV of Appendix E.

5.0 CONCLUSIONS AND RECOMMENDATIONS

The following conclusions and recommendations are prepared from ATL's understanding that the subject buildings of the former Frontier Town park may be subject to renovation and/or demolition projects. Should the management of the buildings change, it is recommended that the findings be revisited to reflect appropriate operations and management practices for hazardous materials containing items.

5.1 General

1. Concealed regulated hazardous materials may exist at the site that could be encountered during future building renovation and/or demolition activities. Wall, ceiling, floor, roofing, and/or other component systems may contain concealed suspect hazardous materials. If any suspect hazardous materials or hazardous materials-containing items are encountered during demolition and/or renovation activities, the activities disturbing the suspect material must stop and the material must be sampled and laboratory analyzed or otherwise managed pursuant to in accordance with applicable regulations.

5.2 Asbestos-Containing Materials

1. The materials listed in bold in Table D-I of Appendix D were determined and assumed to be ACM. The referenced table also shows a material that contains trace concentrations of asbestos and is regulated under OSHA.
2. **Building 2.1 was determined to be an incidental disturbance and will need to have an incidental disturbance assessment performed prior to any abatement and/or renovation activities.**
3. Subpart 56-5(h) of 12 NYCRR Part 56 requires that no demolition, renovation, remodeling, or repair work be commenced by any owner or the owner's agent prior to the completion of asbestos abatement. Asbestos abatement must be performed by an asbestos abatement contractor that maintains a current asbestos handling license, and employs NYSDOL certified asbestos handlers and supervisors. It is recommended that a 12 NYCRR 56 certified Project Monitor oversee abatement activities.
4. Subpart 56-5(g) of 12 NYCRR Part 56 specifies requirements for transmittal of asbestos survey information by the owner or owner's agent. One copy of the asbestos survey report shall be sent to the local government entity charged with issuing a permit for such demolition, renovation, remodeling, or repair work under applicable State or local laws. If controlled demolition or pre-demolition activities will be performed, one copy of the asbestos survey report shall be submitted to the appropriate Asbestos Control Bureau district office. One copy of the asbestos survey report must be kept on the construction site throughout the duration of the asbestos project and any associated demolition, renovation, remodeling, or repair project.

5.3 Lead-Based Paint

1. The materials listed in Table E-I of Appendix E were determined to be LBP per HUD criteria. Table E-II of Appendix E lists materials that are not considered LBP per HUD criteria, but contain detectable concentrations of lead and are regulated under OSHA.
2. Identified LBP or paint with a detectable concentration of lead should be managed in accordance with applicable EPA and OSHA requirements prior to or during demolition, renovation, remodeling, or repair work.
3. Demolition/renovation contractors are required to conduct exposure monitoring or use historical objective data to ensure that employee exposures do not exceed the action level of 30 $\mu\text{g}/\text{m}^3$.

APPENDIX A
LICENSES AND CERTIFICATIONS

Asbestos Certificate Code Classifications

The following letter codes shown on the enclosed asbestos certificates represent the corresponding asbestos classifications:

- | | |
|------------------------------------|--------------------------------------|
| A - Asbestos Handler | F - Operations & Maintenance |
| B - Allied Trades | G - Asbestos Supervisor |
| C - Air Sampling Technician | H - Asbestos Project Monitor |
| D - Building Inspector | I - Asbestos Project Designer |
| E - Management Planner | |

NEW YORK STATE DEPARTMENT OF HEALTH
WADSWORTH CENTER



Expires 12:01 AM April 01, 2024
Issued April 01, 2022
Revised March 30, 2023

CERTIFICATE OF APPROVAL FOR LABORATORY SERVICE

Issued in accordance with and pursuant to section 502 Public Health Law of New York State

*MS. KAROL H. LU
AMERICA SCIENCE TEAM NEW YORK, INC
117 EAST 30TH ST
NEW YORK, NY 10016*

NY Lab Id No: 11480

*is hereby APPROVED as an Environmental Laboratory for the category
ENVIRONMENTAL ANALYSES SOLID AND HAZARDOUS WASTE
All approved subcategories and/or analytes are listed below:*

Miscellaneous

Asbestos in Friable Material	Item 198.1 of Manual EPA 600/M4/82/020
Asbestos in Non-Friable Material-PLM	Item 198.6 of Manual (NOB by PLM)
Asbestos in Non-Friable Material-TEM	Item 198.4 of Manual



Serial No.: 66402

Property of the New York State Department of Health. Certificates are valid only at the address shown and must be conspicuously posted by the laboratory. Continued accreditation depends on the laboratory's successful ongoing participation in the Program. Consumers may verify a laboratory's accreditation status online at <https://apps.health.ny.gov/pubdoh/applinks/wc/elappublicweb/>, by phone (518) 485-5570 or by email to elap@health.ny.gov.

United States Department of Commerce
National Institute of Standards and Technology



Certificate of Accreditation to ISO/IEC 17025:2017

NVLAP LAB CODE: 200546-0

AmeriSci New York

New York, NY

*is accredited by the National Voluntary Laboratory Accreditation Program for specific services,
listed on the Scope of Accreditation, for:*

Asbestos Fiber Analysis

*This laboratory is accredited in accordance with the recognized International Standard ISO/IEC 17025:2017.
This accreditation demonstrates technical competence for a defined scope and the operation of a laboratory quality
management system (refer to joint ISO-ILAC-IAF Communique dated January 2009).*

2023-07-01 through 2024-06-30

Effective Dates



A handwritten signature in blue ink, reading 'Dana S. Laman', is written over a horizontal line.

For the National Voluntary Laboratory Accreditation Program

WE ARE YOUR DOL



Department
of Labor

DIVISION OF SAFETY & HEALTH LICENSE AND CERTIFICATE UNIT, STATE OFFICE CAMPUS, BLDG. 12, ALBANY, NY 12226

ASBESTOS HANDLING LICENSE

Atlantic Testing Laboratories, Limited
P.O. Box 29, Canton, NY, 13617

License Number: 29276

License Class: RESTRICTED

Date of Issue: 10/02/2023

Expiration Date: 11/30/2024

Duly Authorized Representative: Marijean B Remington

This license has been issued in accordance with applicable provisions of Article 30 of the Labor Law of New York State and of the New York State Codes, Rules and Regulations (12 NYCRR Part 56). It is subject to suspension or revocation for a (1) serious violation of state, federal or local laws with regard to the conduct of an asbestos project, or (2) demonstrated lack of responsibility in the conduct of any job involving asbestos or asbestos material.

This license is valid only for the contractor named above and this license or a photocopy must be prominently displayed at the asbestos project worksite. This license verifies that all persons employed by the licensee on an asbestos project in New York State have been issued an Asbestos Certificate, appropriate for the type of work they perform, by the New York State Department of Labor.

A handwritten signature in black ink, appearing to read "Amy Phillips".

Amy Phillips, Director
For the Commissioner of Labor

EXCELSIOR

STATE OF NEW YORK - DEPARTMENT OF LABOR
ASBESTOS CERTIFICATE



JEREMY D FESSETTE
CLASS(EXPIRES)
C ATEC(06/24) D INSP(06/24)
H PM (06/24)

CERT# 12-08708
DMV# 208923804

MUST BE CARRIED ON ASBESTOS PROJECTS



New York State Department of Health Certificate of Asbestos Safety Training

This form is the official record of successful completion of a New York State accredited asbestos safety training course.

Certificate No. **947025**

I - To be completed by Trainee

Name of Trainee (print) <u>Jeremy D Fessette</u>		NYS Depart. of Motor Vehicles ID (DMV ID) ¹ <u>208923804</u>	
Signature of Trainee <u>Webinar</u>		Telephone Number <u>518-335-4297</u>	Date of Birth ¹ <u>06/09/1984</u>
Address <u>130 Arizona Ave. Suite 1540 Plattsburgh, NY 12903</u>			
(Street or PO Box)	(City)	(State)	(Zip Code)

II - To be completed by Training Sponsor

Provider's Name Cornerstone Training Institute		Telephone Number <u>585-319-3625</u>
Address 460 State Street		Course <u>Online</u>
Zip Code Rochester, NY 14608		Location:

Course Title: Inspector Initial Refresher NYS DOH use only
 DOH Equivalency²

Training Language: English Other: _____ Exam Grade/Date: 96% 1/16/24

Dates of Training: From: 01/16/24 To: 01/16/24 Expires: 01/16/25

I certify that the asbestos safety training course given on the above date complied with both 10 NYCRR Part 73 and TSCA Title II, was consistent with the curriculum and instructors approved by the New York State Department of Health, and the trainee receiving this certificate completed the training course and successfully passed the examination.

Training Director²: For Damentehl by Lynn Burington _____
(Print) (Signature)

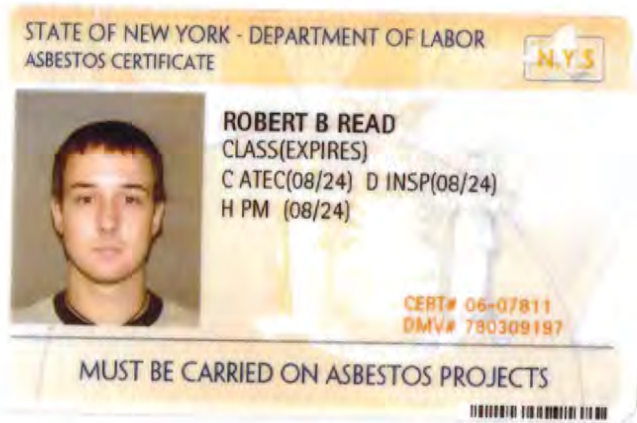

New York State Department of Health Certificate of Asbestos Safety Training
 This form is the official record of successful completion of a New York State accredited asbestos safety training course.

Certificate No. **947032**

I - To be completed by Trainee

Name of Trainee (print) <i>Robert B. Read</i>	NYS Dept. of Motor Vehicles ID (DMV ID) ¹ <i>780309197</i>	
Signature of Trainee <i>Robert B. Read</i>	Telephone Number <i>315-807-8143</i>	Date of Birth ¹ <i>08/04/1986</i>
Address <i>1114 Springfield Rd, Wilmington, NY 12197</i>		
(Street or PO Box)	(City)	(State) (Zip Code)

II - To be completed by Training Sponsor

Provider's Name Cornerstone Training Institute	Telephone Number <i>585 514-3625</i>
Address 460 State Street	Course Location: <i>Online</i>
Zip Code Rochester, NY 14608	

Course Title: *Inspector* Initial Refresher DOH Equivalency² NYS DOH use only

Training Language: English Other: _____ Exam Grade/Date: *100% 1/10/24*

Dates of Training: From: *01/16/24* To: *01/16/24* Expires: *01/16/25*

I certify that the asbestos safety training course given on the above date complied with both 10 NYCRR Part 73 and TSCA Title II, was consistent with the curriculum and instructors approved by the New York State Department of Health, and the trainee receiving this certificate completed the training course and successfully passed the examination.

Training Director²: *For Director: [Signature]* (Print) *[Signature]* (Signature) **STUDENT**

APPENDIX B
SAMPLE LOCATION PLANS

- LEGEND :**
- PL6057AI01A Suspect Asbestos Sample ID and Approximate Location
 - PL6057LX01 Suspect Lead-Based XRF Sample ID and Approximate Location
 - Side A Side Designation for XRF Sampling

- ASBESTOS KEYNOTES :**
- 2 Off-White Sink Coating
 - 3 Gray 9- by 9-Inch Floor Tile
 - 6 Black Paper Vapor Barrier
 - 7 Assumed Inaccessible Building Materials
 - 8 Gray Wall Stucco

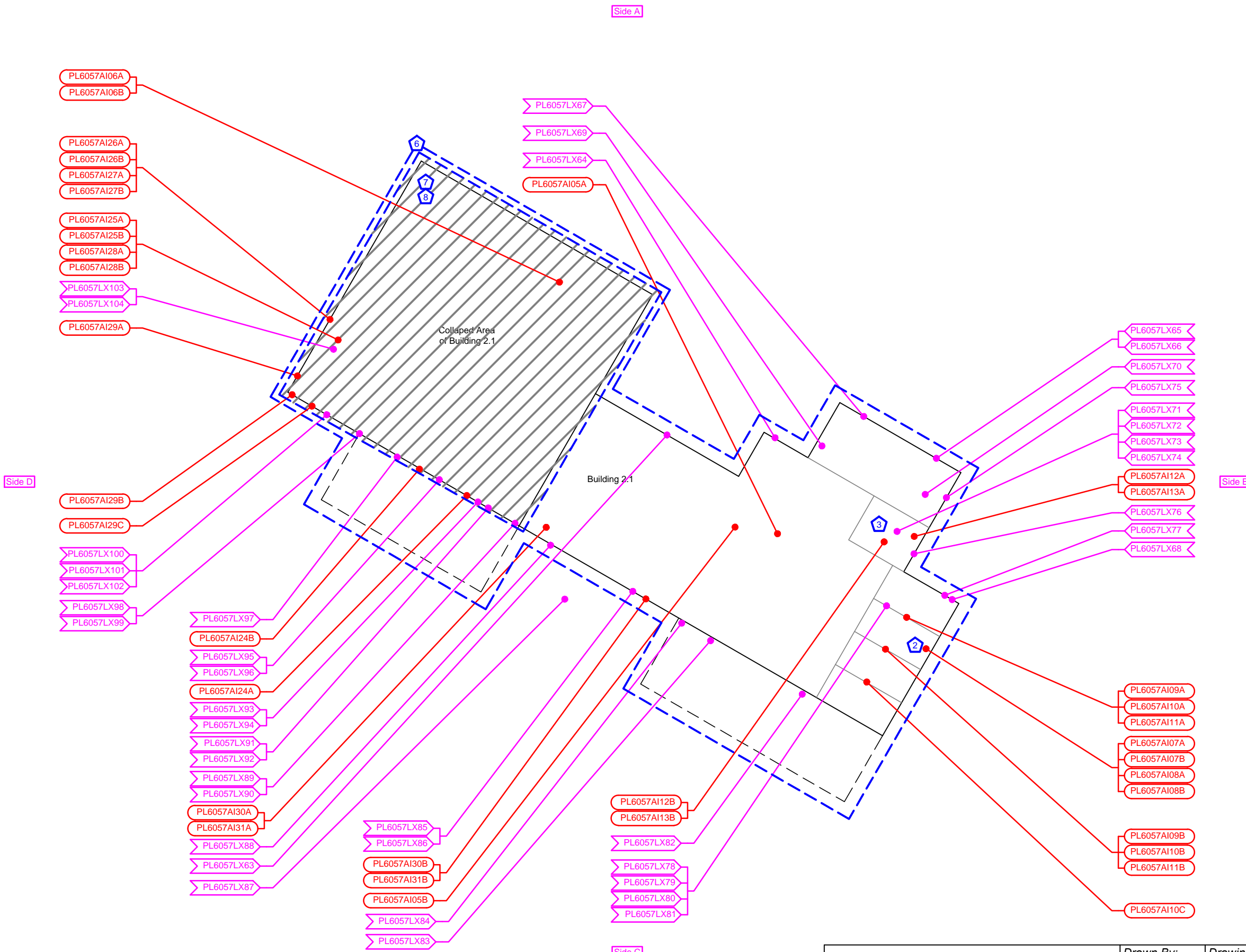
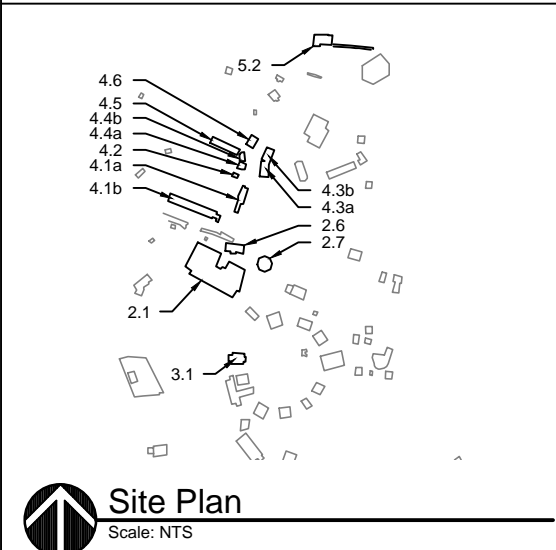

Building 2.1 Sample Location Plan
Scale: NTS

SAMPLE LOCATION PLAN	Drawn By: JDF	Drawing: 1 of 4	Scale: As Noted	Project No.: PL6057	Date: March 2024
-----------------------------	------------------	--------------------	--------------------	------------------------	---------------------

Frontier Town Renovations
4010 Blue Ridge Road
Schroon Lake, New York

ATLANTIC TESTING LABORATORIES, Limited
Albany, NY Binghamton, NY Buffalo, NY Canton, NY Elmira, NY Plattsburgh, NY
Poughkeepsie, NY Rochester, NY Syracuse, NY Utica, NY Watertown, NY

WBE certified company www.AtlanticTesting.com

Side A

LEGEND :

- PL6057AI01A Suspect Asbestos Sample ID and Approximate Location
- PL6057LX01 Suspect Lead-Based XRF Sample ID and Approximate Location
- Side A Side Designation for XRF Sampling

ASBESTOS KEYNOTES :

- 4 Gray 12- by 12-Inch Pattern Floor Tile
- 5 Black Sink Coating

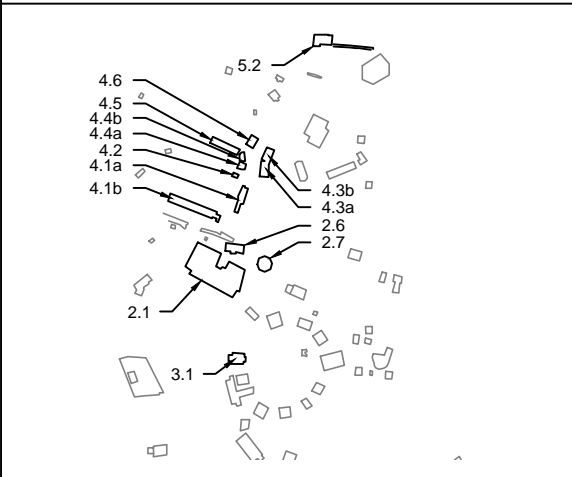
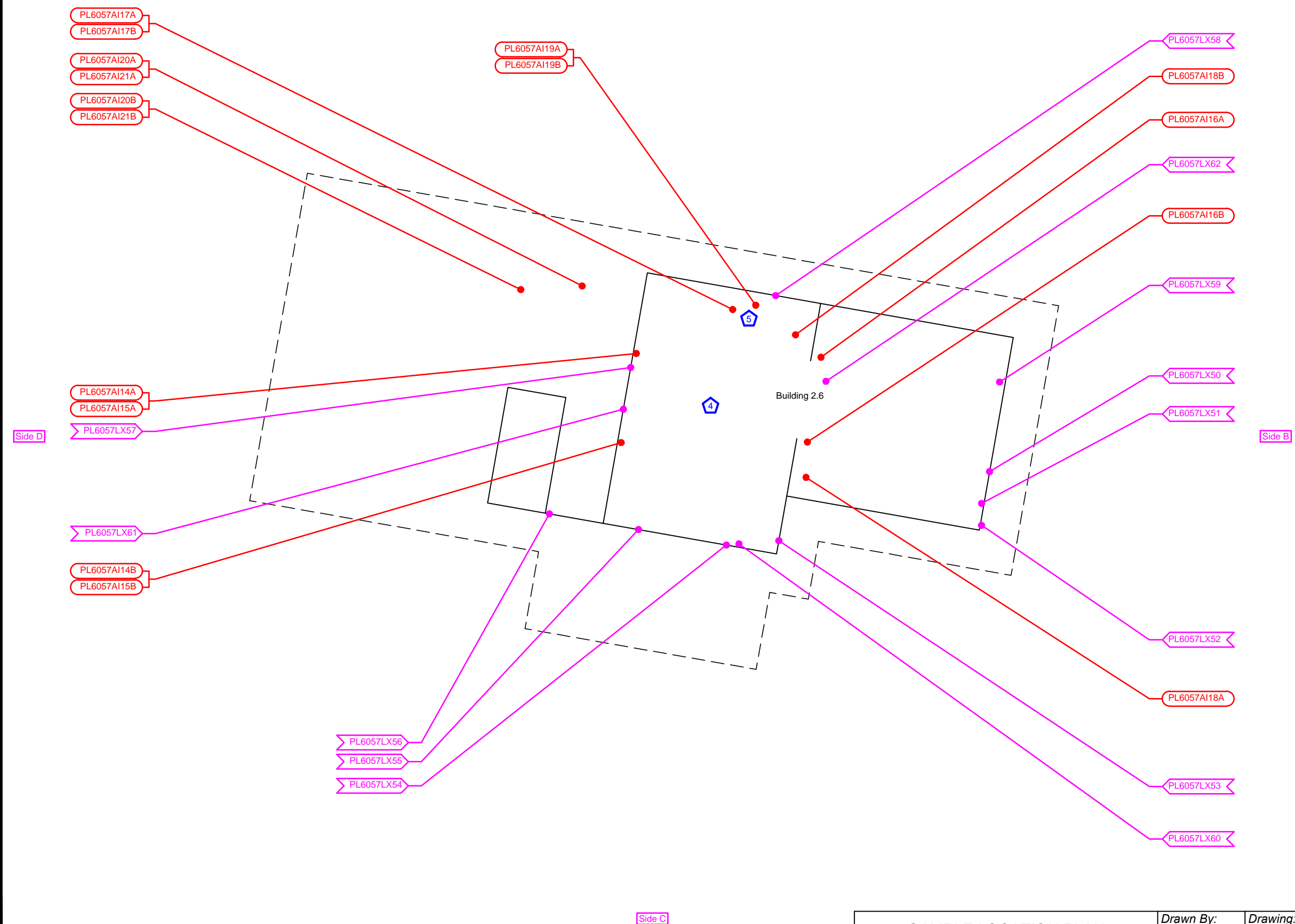

Site Plan
Scale: NTS

Side C

SAMPLE LOCATION PLAN

Drawn By: JDF	Drawing: 2 of 4	Scale: As Noted	Project No.: PL6057	Date : March 2024
------------------	--------------------	--------------------	------------------------	----------------------

Building 2.6 Sample Location Plan
Scale: NTS

Frontier Town Renovations
4010 Blue Ridge Road
Schroon Lake, New York



ATLANTIC TESTING LABORATORIES, Limited

Albany, NY Binghamton, NY Buffalo, NY Canton, NY Elmira, NY Plattsburgh, NY
Poughkeepsie, NY Rochester, NY Syracuse, NY Utica, NY Watertown, NY

WBE certified company

www.AtlanticTesting.com

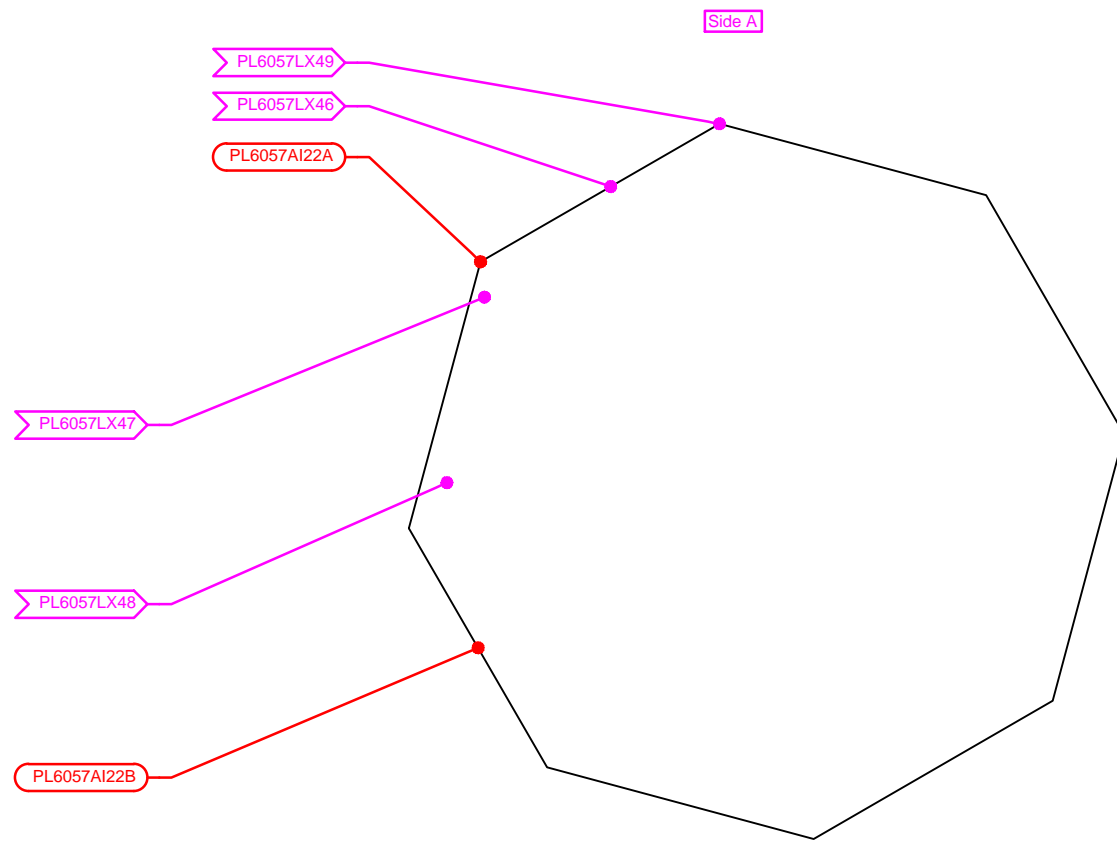

LEGEND :

- PL6057AI01A Suspect Asbestos Sample ID and Approximate Location
- PL6057LX01 Suspect Lead-Based XRF Sample ID and Approximate Location
- Side A Side Designation for XRF Sampling

ASBESTOS KEYNOTES :

Building 2.7 Sample Location Plan
Scale: NTS

Side B

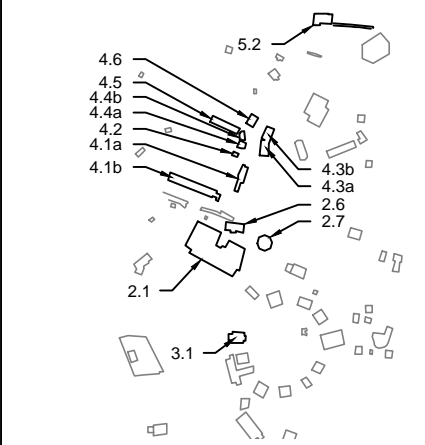
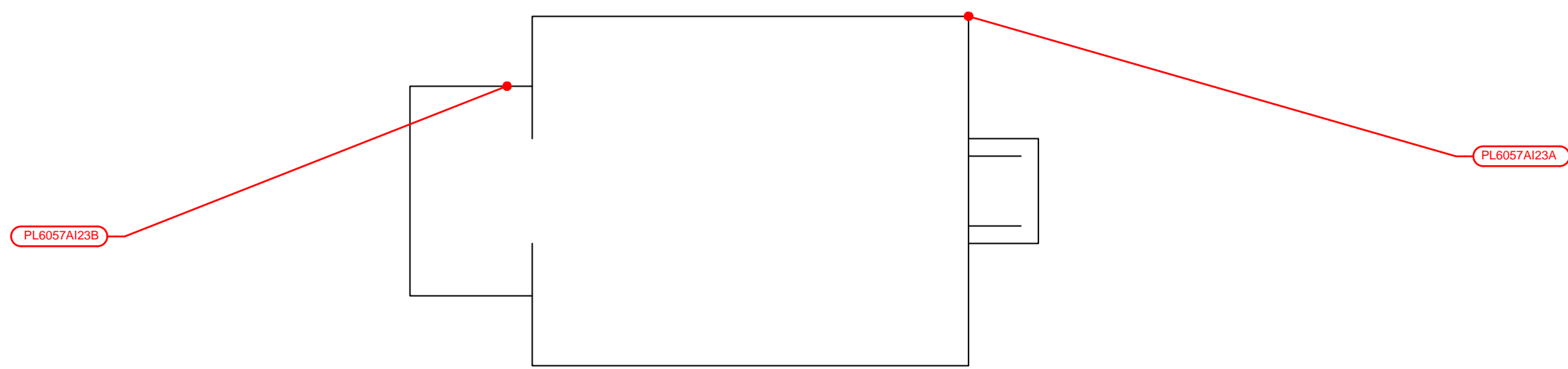

Site Plan
Scale: NTS

Side C

Building 3.1 Sample Location Plan
Scale: NTS

SAMPLE LOCATION PLAN	Drawn By:	Drawing:	Scale:	Project No.:	Date :
	JDF	3 of 4	As Noted	PL6057	March 2024
Frontier Town Renovations 4010 Blue Ridge Road Schroon Lake, New York		ATLANTIC TESTING LABORATORIES, Limited <small>Albany, NY Binghamton, NY Buffalo, NY Canton, NY Elmira, NY Plattsburgh, NY Poughkeepsie, NY Rochester, NY Syracuse, NY Utica, NY Watertown, NY</small> WBE certified company <small>www.AtlanticTesting.com</small>			

Side A

LEGEND :

- PL6057AI01A Suspect Asbestos Sample ID and Approximate Location
- PL6057LX01 Suspect Lead-Based XRF Sample ID and Approximate Location
- Side A Side Designation for XRF Sampling

ASBESTOS KEYNOTES :

- 1 Black Tar

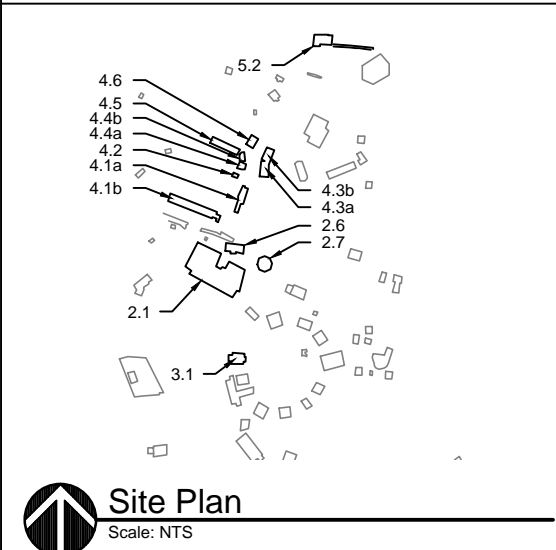
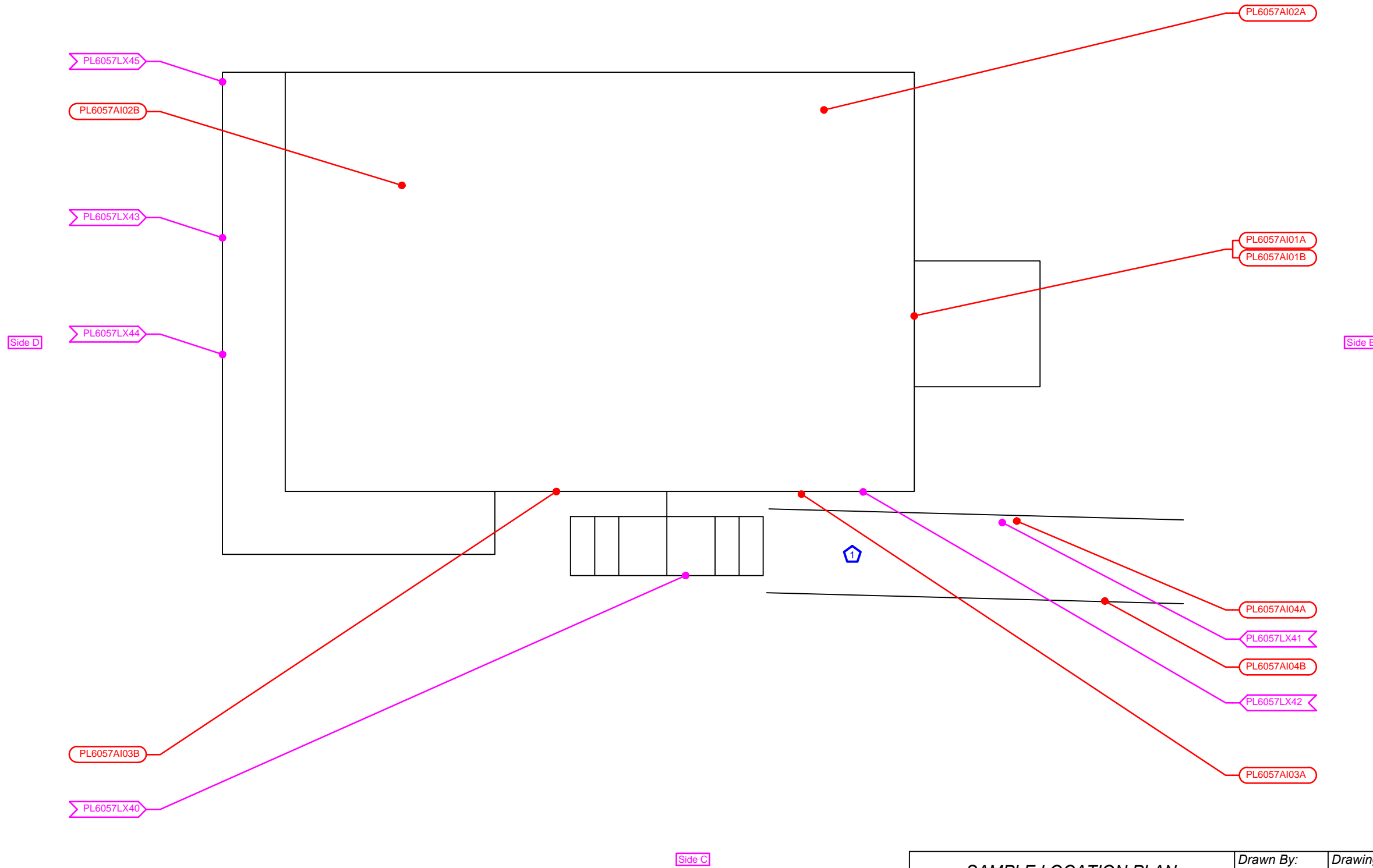

Site Plan
Scale: NTS

Building 5.2 Sample Location Plan
Scale: NTS

SAMPLE LOCATION PLAN	Drawn By:	Drawing:	Scale:	Project No.:	Date :
	JDF	4 of 4	As Noted	PL6057	March 2024
Frontier Town Renovations 4010 Blue Ridge Road Schroon Lake, New York		 ATLANTIC TESTING LABORATORIES, Limited <small>Albany, NY Binghamton, NY Buffalo, NY Canton, NY Elmira, NY Plattsburgh, NY Poughkeepsie, NY Rochester, NY Syracuse, NY Utica, NY Watertown, NY</small> WBE certified company <small>www.AtlanticTesting.com</small>			

APPENDIX C

LABORATORY REPORTS AND CUSTODY DOCUMENTATION

**AmeriSci New York**117 EAST 30TH ST.
NEW YORK, NY 10016
TEL: (212) 679-8600 • FAX: (212) 679-3114

PLM Bulk Asbestos Report

Atlantic Testing Laboratories, Limited
Attn: Robert Read
6431 US Highway 11

Canton, NY 13617**Date Received** 02/02/24 **AmeriSci Job #** 224021210
Date Examined 02/05/24 **P.O. #**
ELAP # 11480 **Page** 1 of 11
RE: PL6057; Frontier Town Renovations; Schroon Lake, New York

Client No. / HGA	Lab No.	Asbestos Present	Total % Asbestos
PL6057AI01A 01	224021210-01 Location: Grist Mill - Row 1: Black Electrical Wire Jacket	No	NAD (by NYS ELAP 198.6) by Valeriu Voicu on 02/05/24
Analyst Description: Black, Homogeneous, Non-Fibrous, Bulk Material Asbestos Types: Other Material: Non-fibrous 11%			
PL6057AI01B 01	224021210-02 Location: Grist Mill - Row 1: Black Electrical Wire Jacket	No	NAD (by NYS ELAP 198.6) by Valeriu Voicu on 02/05/24
Analyst Description: Black, Homogeneous, Non-Fibrous, Bulk Material Asbestos Types: Other Material: Non-fibrous 13.4%			
PL6057AI02A 02	224021210-03 Location: Grist Mill Roof - Row 2: Black Paper Vapor Barrier	No	NAD (by NYS ELAP 198.6) by Valeriu Voicu on 02/05/24
Analyst Description: Black, Homogeneous, Non-Fibrous, Bulk Material Asbestos Types: Other Material: Non-fibrous 0.2%			
PL6057AI02B 02	224021210-04 Location: Grist Mill Roof - Row 2: Black Paper Vapor Barrier	No	NAD (by NYS ELAP 198.6) by Valeriu Voicu on 02/05/24
Analyst Description: Black, Homogeneous, Non-Fibrous, Bulk Material Asbestos Types: Other Material: Non-fibrous 0.6%			
PL6057AI03A 03	224021210-05 Location: Grist Mill Foundation - Row 3: Gray Mortar	No	NAD (by NYS ELAP 198.1) by Valeriu Voicu on 02/05/24
Analyst Description: Black, Homogeneous, Non-Fibrous, Cementitious, Bulk Material Asbestos Types: Other Material: Cellulose Trace, Non-fibrous 100%			

Client Name: Atlantic Testing Laboratories, Limited

PLM Bulk Asbestos Report

PL6057; Frontier Town Renovations; Schroon Lake, New York

Client No. / HGA	Lab No.	Asbestos Present	Total % Asbestos
PL6057AI03B 03	224021210-06 Location: Grist Mill Foundation - Row 3: Gray Mortar	No	NAD (by NYS ELAP 198.1) by Valeriu Voicu on 02/05/24
Analyst Description: Gray, Homogeneous, Non-Fibrous, Cementitious, Bulk Material			
Asbestos Types:			
Other Material: Cellulose Trace, Non-fibrous 100%			
PL6057AI04A 04	224021210-07 Location: Mill Chute - Row 4: Black Tar	Yes	9.2% (by NYS ELAP 198.6) by Valeriu Voicu on 02/05/24
Analyst Description: Black, Homogeneous, Fibrous, Bulk Material			
Asbestos Types: Chrysotile 9.2 %			
Other Material: Non-fibrous 13.8%			
PL6057AI04B 04	224021210-08 Location: Mill Chute - Row 4: Black Tar		NA/PS
Analyst Description: Bulk Material			
Asbestos Types:			
Other Material:			
PL6057AI05A 05	224021210-09 Location: 2.1 Interior - Row 5: Tan Electrical Wire Jacket	No	NAD (by NYS ELAP 198.6) by Valeriu Voicu on 02/05/24
Analyst Description: Tan/Black, Heterogeneous, Fibrous, Bulk Material			
Asbestos Types:			
Other Material: Fibrous glass 20%, Non-fibrous 5.4%			
PL6057AI05B 05	224021210-10 Location: 2.1 Interior - Row 5: Tan Electrical Wire Jacket	No	NAD (by NYS ELAP 198.6) by Valeriu Voicu on 02/05/24
Analyst Description: Tan/Black, Heterogeneous, Fibrous, Bulk Material			
Asbestos Types:			
Other Material: Fibrous glass 40%, Non-fibrous 8.8%			
PL6057AI06A 06	224021210-11 Location: 2.1 Collapsed - Row 6: Black Rolled Roofing	No	NAD (by NYS ELAP 198.6) by Valeriu Voicu on 02/05/24
Analyst Description: Black/Gray, Heterogeneous, Non-Fibrous, Bulk Material			
Asbestos Types:			
Other Material: Non-fibrous 13.9%			

Client Name: Atlantic Testing Laboratories, Limited

PLM Bulk Asbestos Report

PL6057; Frontier Town Renovations; Schroon Lake, New York

Client No. / HGA	Lab No.	Asbestos Present	Total % Asbestos
PL6057AI06B 06	224021210-12 Location: 2.1 Collapsed - Row 6: Black Rolled Roofing	No	NAD (by NYS ELAP 198.6) by Valeriu Voicu on 02/05/24
Analyst Description: Black/Gray, Heterogeneous, Non-Fibrous, Bulk Material Asbestos Types: Other Material: Non-fibrous 15.5%			
PL6057AI07A 07	224021210-13 Location: 2.1 Int - Row 7: Off-White Sink Coating	Yes	2.1% ¹ (ELAP 400 PC) by Valeriu Voicu on 02/05/24
Analyst Description: Off-White/Gray, Homogeneous, Fibrous, Bulk Material Asbestos Types: Chrysotile 2.1 % Other Material: Non-fibrous 47.4%			
PL6057AI07B 07	224021210-14 Location: 2.1 Int - Row 7: Off-White Sink Coating		NA/PS
Analyst Description: Bulk Material Asbestos Types: Other Material:			
PL6057AI08A 08	224021210-15 Location: 2.1 Int - Row 8: Tan Pattern Countertop	No	NAD (by NYS ELAP 198.6) by Valeriu Voicu on 02/05/24
Analyst Description: Tan/Brown, Homogeneous, Non-Fibrous, Bulk Material Asbestos Types: Other Material: Non-fibrous 2.9%			
PL6057AI08B 08	224021210-16 Location: 2.1 Int - Row 8: Tan Pattern Countertop	No	NAD (by NYS ELAP 198.6) by Valeriu Voicu on 02/05/24
Analyst Description: Tan/Brown, Homogeneous, Non-Fibrous, Bulk Material Asbestos Types: Other Material: Non-fibrous 2.1%			
PL6057AI09A 09	224021210-17 Location: 2.1 Int - Row 9: White Gypsum Board	No	NAD (by NYS ELAP 198.1) by Valeriu Voicu on 02/05/24
Analyst Description: White, Homogeneous, Fibrous, Bulk Material Asbestos Types: Other Material: Cellulose 2%, Non-fibrous 98%			

See Reporting notes on last page

PLM Bulk Asbestos Report

PL6057; Frontier Town Renovations; Schroon Lake, New York

Client No. / HGA	Lab No.	Asbestos Present	Total % Asbestos
PL6057AI09B 09	224021210-18 Location: 2.1 Int - Row 9: White Gypsum Board	No	NAD (by NYS ELAP 198.1) by Valeriu Voicu on 02/05/24
Analyst Description: White, Homogeneous, Fibrous, Bulk Material			
Asbestos Types:			
Other Material: Cellulose 2%, Non-fibrous 98%			
PL6057AI10A 10	224021210-19 Location: 2.1 Int - Row 10: White Gypsum Board Associated White Joint Compound Row 9	No	NAD (by NYS ELAP 198.1) by Valeriu Voicu on 02/05/24
Analyst Description: White, Homogeneous, Non-Fibrous, Bulk Material			
Asbestos Types:			
Other Material: Cellulose Trace, Non-fibrous 100%			
PL6057AI10B 10	224021210-20 Location: 2.1 Int - Row 10: White Gypsum Board Associated White Joint Compound Row 9	No	NAD (by NYS ELAP 198.1) by Valeriu Voicu on 02/05/24
Analyst Description: White, Homogeneous, Non-Fibrous, Bulk Material			
Asbestos Types:			
Other Material: Cellulose Trace, Non-fibrous 100%			
PL6057AI10C 10	224021210-21 Location: 2.1 Int - Row 10: White Gypsum Board Associated White Joint Compound Row 9	No	NAD (by NYS ELAP 198.1) by Valeriu Voicu on 02/05/24
Analyst Description: White, Homogeneous, Non-Fibrous, Bulk Material			
Asbestos Types:			
Other Material: Cellulose Trace, Non-fibrous 100%			
PL6057AI11A 11	224021210-22 Location: 2.1 Int - Row 11: White Gypsum Board Associated Tan Seam Tape Row 9	No	NAD (by NYS ELAP 198.1) by Valeriu Voicu on 02/05/24
Analyst Description: Cream, Homogeneous, Fibrous, Bulk Material			
Asbestos Types:			
Other Material: Cellulose 90%, Non-fibrous 10%			
PL6057AI11B 11	224021210-23 Location: 2.1 Int - Row 11: White Gypsum Board Associated Tan Seam Tape Row 9	No	NAD (by NYS ELAP 198.1) by Valeriu Voicu on 02/05/24
Analyst Description: Cream, Homogeneous, Fibrous, Bulk Material			
Asbestos Types:			
Other Material: Cellulose 90%, Non-fibrous 10%			

PLM Bulk Asbestos Report

PL6057; Frontier Town Renovations; Schroon Lake, New York

Client No. / HGA	Lab No.	Asbestos Present	Total % Asbestos
PL6057AI12A 12	224021210-24 Location: 2.1 Int - Row 12: Gray 9- By 9-Inch Floor Tile	Yes	1.7% (by NYS ELAP 198.6) by Valeriu Voicu on 02/05/24
Analyst Description: Gray, Heterogeneous, Fibrous, Bulk Material			
Asbestos Types: Chrysotile 1.7 %			
Other Material: Non-fibrous 12.1%			
PL6057AI12B 12	224021210-25 Location: 2.1 Int - Row 12: Gray 9- By 9-Inch Floor Tile		NA/PS
Analyst Description: Bulk Material			
Asbestos Types:			
Other Material:			
PL6057AI13A 13	224021210-26 Location: 2.1 Int - Row 13: Black Flooring Vapor Barrier Row 12	No	NAD (by NYS ELAP 198.6) by Valeriu Voicu on 02/05/24
Analyst Description: Black, Heterogeneous, Non-Fibrous, Bulk Material			
Asbestos Types:			
Other Material: Non-fibrous 19.3%			
PL6057AI13B 13	224021210-27 Location: 2.1 Int - Row 13: Black Flooring Vapor Barrier Row 12	No	NAD (by NYS ELAP 198.6) by Valeriu Voicu on 02/05/24
Analyst Description: Black, Homogeneous, Non-Fibrous, Bulk Material			
Asbestos Types:			
Other Material: Non-fibrous 18%			
PL6057AI14A 14	224021210-28 Location: 2.6 Int - Row 14: Gray 12- By 12-Inch Pattern Floor Tile	Yes	2.1% (by NYS ELAP 198.6) by Valeriu Voicu on 02/05/24
Analyst Description: Gray, Homogeneous, Fibrous, Bulk Material			
Asbestos Types: Chrysotile 2.1 %			
Other Material: Non-fibrous 10.6%			
PL6057AI14B 14	224021210-29 Location: 2.6 Int - Row 14: Gray 12- By 12-Inch Pattern Floor Tile		NA/PS
Analyst Description: Bulk Material			
Asbestos Types:			
Other Material:			

PLM Bulk Asbestos Report

PL6057; Frontier Town Renovations; Schroon Lake, New York

Client No. / HGA	Lab No.	Asbestos Present	Total % Asbestos
PL6057AI15A 15	224021210-30 Location: 2.6 Int - Row 15: Yellow Adhesive Associated With Row 14	No	NAD (by NYS ELAP 198.6) by Valeriu Voicu on 02/05/24
Analyst Description: Yellow, Heterogeneous, Non-Fibrous, Bulk Material			
Asbestos Types:			
Other Material: Non-fibrous 1.9%			
PL6057AI15B 15	224021210-31 Location: 2.6 Interior - Row 15: Yellow Adhesive Associated With Row 14	No	NAD (by NYS ELAP 198.6) by Valeriu Voicu on 02/05/24
Analyst Description: Yellow, Homogeneous, Non-Fibrous, Bulk Material			
Asbestos Types:			
Other Material: Non-fibrous 1.1%			
PL6057AI16A 16	224021210-32 Location: 2.6 Interior - Row 16: Tan 12- By 12-Inch Pattern Linoleum	No	NAD (by NYS ELAP 198.6) by Valeriu Voicu on 02/05/24
Analyst Description: Tan/Brown, Homogeneous, Non-Fibrous, Bulk Material			
Asbestos Types:			
Other Material: Non-fibrous 17.4%			
PL6057AI16B 16	224021210-33 Location: 2.6 Interior - Row 16: Tan 12- By 12-Inch Pattern Linoleum	No	NAD (by NYS ELAP 198.6) by Valeriu Voicu on 02/05/24
Analyst Description: Tan/Brown, Homogeneous, Non-Fibrous, Bulk Material			
Asbestos Types:			
Other Material: Non-fibrous 28.5%			
PL6057AI17A 17	224021210-34 Location: 2.6 Interior - Row 17: Black Sink Coating	Yes	Trace (<0.25 % pc) ¹ (ELAP 400 PC) by Valeriu Voicu on 02/05/24
Analyst Description: Black, Homogeneous, Non-Fibrous, Bulk Material			
Asbestos Types: Chrysotile <0.25 % pc			
Other Material: Non-fibrous 55.1%			
PL6057AI17B 17	224021210-35 Location: 2.6 Interior - Row 17: Black Sink Coating	Yes	Trace (<0.25 % pc) ¹ (ELAP 400 PC) by Valeriu Voicu on 02/05/24
Analyst Description: Black, Homogeneous, Non-Fibrous, Bulk Material			
Asbestos Types: Chrysotile <0.25 % pc			
Other Material: Non-fibrous 23%			

PLM Bulk Asbestos Report

PL6057; Frontier Town Renovations; Schroon Lake, New York

Client No. / HGA	Lab No.	Asbestos Present	Total % Asbestos
PL6057AI18A 18	224021210-36 Location: 2.6 Interior - Row 18: Tan Pattern Countertop	No	NAD (by NYS ELAP 198.6) by Valeriu Voicu on 02/05/24
Analyst Description: Tan, Homogeneous, Non-Fibrous, Bulk Material			
Asbestos Types:			
Other Material: Non-fibrous 2.3%			
PL6057AI18B 18	224021210-37 Location: 2.6 Interior - Row 18: Tan Pattern Countertop	No	NAD (by NYS ELAP 198.6) by Valeriu Voicu on 02/05/24
Analyst Description: Tan, Homogeneous, Non-Fibrous, Bulk Material			
Asbestos Types:			
Other Material: Non-fibrous 2%			
PL6057AI19A 19	224021210-38 Location: 2.6 Interior - Row 19: White Fixture Caulk	No	NAD (by NYS ELAP 198.6) by Valeriu Voicu on 02/05/24
Analyst Description: Off-White/Brown, Heterogeneous, Non-Fibrous, Bulk Material			
Asbestos Types:			
Other Material: Non-fibrous 36%			
PL6057AI19B 19	224021210-39 Location: 2.6 Interior - Row 19: White Fixture Caulk	No	NAD (by NYS ELAP 198.6) by Valeriu Voicu on 02/05/24
Analyst Description: Off-White/Brown, Heterogeneous, Non-Fibrous, Bulk Material			
Asbestos Types:			
Other Material: Non-fibrous 30.5%			
PL6057AI20A 20	224021210-40 Location: 2.6 Roof - Row 20: Brown Asphalt Shingle	No	NAD (by NYS ELAP 198.6) by Valeriu Voicu on 02/05/24
Analyst Description: Black, Homogeneous, Non-Fibrous, Bulk Material			
Asbestos Types:			
Other Material: Non-fibrous 3.5%			
PL6057AI20B 20	224021210-41 Location: 2.6 Roof - Row 20: Brown Asphalt Shingle	No	NAD (by NYS ELAP 198.6) by Valeriu Voicu on 02/05/24
Analyst Description: Black, Homogeneous, Non-Fibrous, Bulk Material			
Asbestos Types:			
Other Material: Non-fibrous 3.3%			

Client Name: Atlantic Testing Laboratories, Limited

PLM Bulk Asbestos Report

PL6057; Frontier Town Renovations; Schroon Lake, New York

Client No. / HGA	Lab No.	Asbestos Present	Total % Asbestos
PL6057AI21A 21	224021210-42 Location: 2.6 Roof - Row 21: Black Vapor Barrier Row 20	No	NAD (by NYS ELAP 198.6) by Valeriu Voicu on 02/05/24
Analyst Description: Black, Homogeneous, Non-Fibrous, Bulk Material			
Asbestos Types:			
Other Material: Non-fibrous 1.1%			
PL6057AI21B 21	224021210-43 Location: 2.6 Roof - Row 21: Black Vapor Barrier Row 20	No	NAD (by NYS ELAP 198.6) by Valeriu Voicu on 02/05/24
Analyst Description: Black, Homogeneous, Non-Fibrous, Bulk Material			
Asbestos Types:			
Other Material: Non-fibrous 3.9%			
PL6057AI22A 22	224021210-44 Location: 2.7 Roof - Row 22: Black Vapor Barrier	No	NAD (by NYS ELAP 198.6) by Valeriu Voicu on 02/05/24
Analyst Description: Black, Homogeneous, Non-Fibrous, Bulk Material			
Asbestos Types:			
Other Material: Non-fibrous 0.6%			
PL6057AI22B 22	224021210-45 Location: 2.7 Roof - Row 22: Black Vapor Barrier	No	NAD (by NYS ELAP 198.6) by Valeriu Voicu on 02/05/24
Analyst Description: Black, Homogeneous, Non-Fibrous, Bulk Material			
Asbestos Types:			
Other Material: Non-fibrous 1%			
PL6057AI23A 23	224021210-46 Location: 3.1 Roof - Row 23: Black Vapor Barrier	No	NAD (by NYS ELAP 198.6) by Valeriu Voicu on 02/05/24
Analyst Description: Black, Homogeneous, Non-Fibrous, Bulk Material			
Asbestos Types:			
Other Material: Non-fibrous 2.8%			
PL6057AI23B 23	224021210-47 Location: 3.1 Roof - Row 23: Black Vapor Barrier	No	NAD (by NYS ELAP 198.6) by Valeriu Voicu on 02/05/24
Analyst Description: Black, Homogeneous, Non-Fibrous, Bulk Material			
Asbestos Types:			
Other Material: Non-fibrous 2.3%			

PLM Bulk Asbestos Report

PL6057; Frontier Town Renovations; Schroon Lake, New York

Client No. / HGA	Lab No.	Asbestos Present	Total % Asbestos
PL6057AI24A 24	224021210-48 Location: 2.1 Ext - Row 24: Off-White Residual Window Glazing	Yes	Trace (<0.25 % pc) ¹ (ELAP 400 PC) by Valeriu Voicu on 02/05/24
Analyst Description: Off-White/Gray, Heterogeneous, Non-Fibrous, Bulk Material Asbestos Types: Chrysotile <0.25 % pc Other Material: Non-fibrous 7.9%			
PL6057AI24B 24	224021210-49 Location: 2.1 Ext - Row 24: Off-White Residual Window Glazing	Yes	Trace (<1 %) ¹ (by NYS ELAP 198.6) by Valeriu Voicu on 02/05/24
Analyst Description: Off-White/Gray, Heterogeneous, Non-Fibrous, Bulk Material Asbestos Types: Chrysotile <1 % pc Other Material: Non-fibrous 4.4%			
PL6057AI25A 25	224021210-50 Location: 2.1 Bath - Row 25: White 2- By 4-Foot Paper Ceiling Tile	No	NAD (by NYS ELAP 198.1) by Valeriu Voicu on 02/05/24
Analyst Description: White/Silver/Tan, Heterogeneous, Fibrous, Bulk Material Asbestos Types: Other Material: Cellulose 35%, Fibrous glass 10%, Non-fibrous 55%			
PL6057AI25B 25	224021210-51 Location: 2.1 Bath - Row 25: White 2- By 4-Foot Paper Ceiling Tile	No	NAD (by NYS ELAP 198.1) by Valeriu Voicu on 02/05/24
Analyst Description: White/Silver/Yellow, Heterogeneous, Fibrous, Bulk Material Asbestos Types: Other Material: Cellulose 20%, Fibrous glass 40%, Non-fibrous 40%			
PL6057AI26A 26	224021210-52 Location: 2.1 Bath - Row 26: White CWT Grout	No	NAD (by NYS ELAP 198.1) by Valeriu Voicu on 02/05/24
Analyst Description: White, Homogeneous, Non-Fibrous, Bulk Material Asbestos Types: Other Material: Cellulose Trace, Non-fibrous 100%			
PL6057AI26B 26	224021210-53 Location: 2.1 Bath - Row 26: White CWT Grout	No	NAD (by NYS ELAP 198.1) by Valeriu Voicu on 02/05/24
Analyst Description: White, Homogeneous, Non-Fibrous, Bulk Material Asbestos Types: Other Material: Cellulose Trace, Non-fibrous 100%			

PLM Bulk Asbestos Report

PL6057; Frontier Town Renovations; Schroon Lake, New York

Client No. / HGA	Lab No.	Asbestos Present	Total % Asbestos
PL6057AI27A 27	224021210-54 Location: 2.1 Bath - Row 27: Yellow CWT Adhesive Row 26	No	NAD (by NYS ELAP 198.6) by Valeriu Voicu on 02/05/24
Analyst Description: Yellow, Homogeneous, Non-Fibrous, Bulk Material			
Asbestos Types:			
Other Material: Non-fibrous 14.1%			
PL6057AI27B 27	224021210-55 Location: 2.1 Bath - Row 27: Yellow CWT Adhesive Row 26	No	NAD (by NYS ELAP 198.6) by Valeriu Voicu on 02/05/24
Analyst Description: Yellow, Homogeneous, Non-Fibrous, Bulk Material			
Asbestos Types:			
Other Material: Non-fibrous 16.6%			
PL6057AI28A 28	224021210-56 Location: 2.1 Bath - Row 28: Off-White Textured Sheet Flooring	No	NAD (by NYS ELAP 198.6) by Valeriu Voicu on 02/05/24
Analyst Description: Beige, Homogeneous, Non-Fibrous, Bulk Material			
Asbestos Types:			
Other Material: Non-fibrous 0.1%			
PL6057AI28B 28	224021210-57 Location: 2.1 Bath - Row 28: Off-White Textured Sheet Flooring	No	NAD (by NYS ELAP 198.6) by Valeriu Voicu on 02/05/24
Analyst Description: Beige, Homogeneous, Non-Fibrous, Bulk Material			
Asbestos Types:			
Other Material: Non-fibrous 0.2%			
PL6057AI29A 29	224021210-58 Location: 2.1 Siding - Row 29: Gray Wall Stucco	No	NAD (by NYS ELAP 198.1) by Valeriu Voicu on 02/05/24
Analyst Description: Dark Gray, Homogeneous, Non-Fibrous, Cementitious, Bulk Material			
Asbestos Types:			
Other Material: Cellulose Trace, Non-fibrous 100%			
PL6057AI29B 29	224021210-59 Location: 2.1 Siding - Row 29: Gray Wall Stucco	No	NAD (by NYS ELAP 198.1) by Valeriu Voicu on 02/05/24
Analyst Description: Dark Gray, Homogeneous, Non-Fibrous, Cementitious, Bulk Material			
Asbestos Types:			
Other Material: Cellulose Trace, Non-fibrous 100%			

PLM Bulk Asbestos Report

PL6057; Frontier Town Renovations; Schroon Lake, New York

Client No. / HGA	Lab No.	Asbestos Present	Total % Asbestos
PL6057AI30A 30	224021210-60 Location: 2.1 Roof - Row 30: Gray Speckled Asphalt Shingle	No	NAD (by NYS ELAP 198.6) by Valeriu Voicu on 02/05/24
Analyst Description: Gray/Black, Homogeneous, Non-Fibrous, Bulk Material			
Asbestos Types:			
Other Material: Non-fibrous 44.1%			
PL6057AI30B 30	224021210-61 Location: 2.1 Roof - Row 30: Gray Speckled Asphalt Shingle	No	NAD (by NYS ELAP 198.6) by Valeriu Voicu on 02/05/24
Analyst Description: Gray/Black, Homogeneous, Non-Fibrous, Bulk Material			
Asbestos Types:			
Other Material: Non-fibrous 46%			
PL6057AI31A 31	224021210-62 Location: 2.1 Roof - Row 31: Black Paper Vapor Barrier Row 30	Yes	7.8% (by NYS ELAP 198.6) by Valeriu Voicu on 02/05/24
Analyst Description: Black, Homogeneous, Fibrous, Bulk Material			
Asbestos Types: Chrysotile 7.7 %			
Other Material: Non-fibrous 32.9%			
PL6057AI31B 31	224021210-63 Location: 2.1 Roof - Row 31: Black Paper Vapor Barrier Row 30		NA/PS
Analyst Description: Bulk Material			
Asbestos Types:			
Other Material:			

Reporting Notes:

(1) Sample prepared for analysis by ELAP 198.6 method

Analyzed by: Valeriu Voicu
Date: 2/5/2024



Reviewed by: Hongyan Ran



*NAD/NSD =no asbestos detected; NA =not analyzed; NA/PS=not analyzed/positive stop, (SOF-V) = Sprayed On Fireproofing containing Vermiculite; (SM-V) = Surfacing Material containing Vermiculite; PLM Bulk Asbestos Analysis using Olympus, Model BH-2 Pol Scope, Microscope, Serial #: 229915, by Appd E to Subpt E, 40 CFR 763 quantified by either CVES or 400 pt ct as noted for each analysis (NVLAP 200546-0), ELAP PLM Method 198.1 for NY friable samples, which includes the identification and quantitation of vermiculite, or ELAP 198.6 for NOB samples, or EPA 400 pt ct by EPA 600-M4-82-020 (NY ELAP Lab 11480); Note:PLM is not consistently reliable in detecting asbestos in floor coverings and similar non-friable organically bound materials. NAD or Trace results by PLM are inconclusive, TEM is currently the only method that can be used to determine if this material can be considered or treated as non asbestos-containing in NY State (also see EPA Advisory for floor tile, FR 59,146,38970,8/1/94) National Institute of Standards and Technology Accreditation requirements mandate that this report must not be reproduced except in full without the approval of the lab.This PLM report relates ONLY to the items tested. RI Cert AAL-094, CT Cert PH-0186, Mass Cert AA000054, NJ Lab ID #NY031.

Client Name: Atlantic Testing Laboratories, Limited

Table I
Summary of Bulk Asbestos Analysis Results
 PL6057; Frontier Town Renovations; Schroon Lake, New York

AmeriSci Sample #	Client Sample#	HG Area	Sample Weight (gram)	Heat Sensitive Organic %	Acid Soluble Inorganic %	Insoluble Non-Asbestos Inorganic %	** Asbestos % by PLM/DS	** Asbestos % by TEM
01	PL6057AI01A	01	0.418	86.5	2.4	11.0	NAD	NAD
	Location: Grist Mill - Row 1: Black Electrical Wire Jacket							
02	PL6057AI01B	01	0.314	82.9	3.7	13.4	NAD	NAD
	Location: Grist Mill - Row 1: Black Electrical Wire Jacket							
03	PL6057AI02A	02	0.179	97.8	2.0	0.2	NAD	NAD
	Location: Grist Mill Roof - Row 2: Black Paper Vapor Barrier							
04	PL6057AI02B	02	0.279	98.1	1.3	0.6	NAD	NAD
	Location: Grist Mill Roof - Row 2: Black Paper Vapor Barrier							
05	PL6057AI03A	03	----	----	----	----	NAD	NA
	Location: Grist Mill Foundation - Row 3: Gray Mortar							
06	PL6057AI03B	03	----	----	----	----	NAD	NA
	Location: Grist Mill Foundation - Row 3: Gray Mortar							
07	PL6057AI04A	04	0.420	72.8	4.2	13.8	Chrysotile 9.2	NA
	Location: Mill Chute - Row 4: Black Tar							
08	PL6057AI04B	04	0.518	73.3	4.2	22.5	NA/PS	NA
	Location: Mill Chute - Row 4: Black Tar							
09	PL6057AI05A	05	0.131	71.9	2.7	25.4	NAD	NAD
	Location: 2.1 Interior - Row 5: Tan Electrical Wire Jacket							
10	PL6057AI05B	05	0.232	48.8	2.5	48.8	NAD	NAD
	Location: 2.1 Interior - Row 5: Tan Electrical Wire Jacket							
11	PL6057AI06A	06	0.422	82.5	3.6	13.9	NAD	NAD
	Location: 2.1 Collapsed - Row 6: Black Rolled Roofing							
12	PL6057AI06B	06	0.512	79.8	4.7	15.5	NAD	NAD
	Location: 2.1 Collapsed - Row 6: Black Rolled Roofing							
13	PL6057AI07A	07	0.204	18.7	31.8	47.4	Chrysotile 2.1	NA
	Location: 2.1 Int - Row 7: Off-White Sink Coating							
14	PL6057AI07B	07	0.183	21.3	31.5	47.3	NA/PS	NA
	Location: 2.1 Int - Row 7: Off-White Sink Coating							
15	PL6057AI08A	08	0.234	95.2	1.9	2.9	NAD	NAD
	Location: 2.1 Int - Row 8: Tan Pattern Countertop							
16	PL6057AI08B	08	0.203	93.9	4.0	2.1	NAD	NAD
	Location: 2.1 Int - Row 8: Tan Pattern Countertop							

See Reporting notes on last page

Client Name: Atlantic Testing Laboratories, Limited

Table I
Summary of Bulk Asbestos Analysis Results
 PL6057; Frontier Town Renovations; Schroon Lake, New York

AmeriSci Sample #	Client Sample#	HG Area	Sample Weight (gram)	Heat Sensitive Organic %	Acid Soluble Inorganic %	Insoluble Non-Asbestos Inorganic %	** Asbestos % by PLM/DS	** Asbestos % by TEM
17	PL6057AI09A	09	----	----	----	----	NAD	NA
	Location: 2.1 Int - Row 9: White Gypsum Board							
18	PL6057AI09B	09	----	----	----	----	NAD	NA
	Location: 2.1 Int - Row 9: White Gypsum Board							
19	PL6057AI10A	10	----	----	----	----	NAD	NA
	Location: 2.1 Int - Row 10: White Gypsum Board Associated White Joint Compound Row 9							
20	PL6057AI10B	10	----	----	----	----	NAD	NA
	Location: 2.1 Int - Row 10: White Gypsum Board Associated White Joint Compound Row 9							
21	PL6057AI10C	10	----	----	----	----	NAD	NA
	Location: 2.1 Int - Row 10: White Gypsum Board Associated White Joint Compound Row 9							
22	PL6057AI11A	11	----	----	----	----	NAD	NA
	Location: 2.1 Int - Row 11: White Gypsum Board Associated Tan Seam Tape Row 9							
23	PL6057AI11B	11	----	----	----	----	NAD	NA
	Location: 2.1 Int - Row 11: White Gypsum Board Associated Tan Seam Tape Row 9							
24	PL6057AI12A	12	0.278	58.1	28.1	12.1	Chrysotile 1.7	NA
	Location: 2.1 Int - Row 12: Gray 9- By 9-Inch Floor Tile							
25	PL6057AI12B	12	0.277	57.1	27.5	15.3	NA/PS	NA
	Location: 2.1 Int - Row 12: Gray 9- By 9-Inch Floor Tile							
26	PL6057AI13A	13	0.272	77.5	3.2	19.3	NAD	NAD
	Location: 2.1 Int - Row 13: Black Flooring Vapor Barrier Row 12							
27	PL6057AI13B	13	0.302	78.2	3.8	18.0	NAD	NAD
	Location: 2.1 Int - Row 13: Black Flooring Vapor Barrier Row 12							
28	PL6057AI14A	14	0.311	24.4	62.9	10.6	Chrysotile 2.1	NA
	Location: 2.6 Int - Row 14: Gray 12- By 12-Inch Pattern Floor Tile							
29	PL6057AI14B	14	0.302	22.8	64.7	12.4	NA/PS	NA
	Location: 2.6 Int - Row 14: Gray 12- By 12-Inch Pattern Floor Tile							
30	PL6057AI15A	15	0.329	36.5	61.6	1.9	NAD	NAD
	Location: 2.6 Int - Row 15: Yellow Adhesive Associated With Row 14							
31	PL6057AI15B	15	0.225	36.3	62.6	1.1	NAD	NAD
	Location: 2.6 Interior - Row 15: Yellow Adhesive Associated With Row 14							
32	PL6057AI16A	16	0.358	21.5	61.1	17.4	NAD	NAD
	Location: 2.6 Interior - Row 16: Tan 12- By 12-Inch Pattern Linoleum							

See Reporting notes on last page

Client Name: Atlantic Testing Laboratories, Limited

Table I
Summary of Bulk Asbestos Analysis Results
 PL6057; Frontier Town Renovations; Schroon Lake, New York

AmeriSci Sample #	Client Sample#	HG Area	Sample Weight (gram)	Heat Sensitive Organic %	Acid Soluble Inorganic %	Insoluble Non-Asbestos Inorganic %	** Asbestos % by PLM/DS	** Asbestos % by TEM
33	PL6057A116B	16	0.377	21.1	50.4	28.5	NAD	NAD
	Location: 2.6 Interior - Row 16: Tan 12- By 12-Inch Pattern Linoleum							
34	PL6057A117A	17	0.411	17.0	27.9	46.8	Chrysotile <0.25	Chrysotile 8.3
	Location: 2.6 Interior - Row 17: Black Sink Coating							
35	PL6057A117B	17	0.298	17.8	59.1	23.0	Chrysotile <0.25	NA/PS
	Location: 2.6 Interior - Row 17: Black Sink Coating							
36	PL6057A118A	18	0.206	96.3	1.4	2.3	NAD	NAD
	Location: 2.6 Interior - Row 18: Tan Pattern Countertop							
37	PL6057A118B	18	0.194	96.7	1.2	2.0	NAD	NAD
	Location: 2.6 Interior - Row 18: Tan Pattern Countertop							
38	PL6057A119A	19	0.312	34.2	29.8	36.0	NAD	NAD
	Location: 2.6 Interior - Row 19: White Fixture Caulk							
39	PL6057A119B	19	0.335	37.1	32.4	30.5	NAD	NAD
	Location: 2.6 Interior - Row 19: White Fixture Caulk							
40	PL6057A120A	20	0.452	80.6	15.9	3.5	NAD	NAD
	Location: 2.6 Roof - Row 20: Brown Asphalt Shingle							
41	PL6057A120B	20	0.436	77.9	18.8	3.3	NAD	NAD
	Location: 2.6 Roof - Row 20: Brown Asphalt Shingle							
42	PL6057A121A	21	0.473	98.0	0.9	1.1	NAD	NAD
	Location: 2.6 Roof - Row 21: Black Vapor Barrier Row 20							
43	PL6057A121B	21	0.394	87.0	9.1	3.9	NAD	NAD
	Location: 2.6 Roof - Row 21: Black Vapor Barrier Row 20							
44	PL6057A122A	22	0.274	98.4	0.9	0.6	NAD	NAD
	Location: 2.7 Roof - Row 22: Black Vapor Barrier							
45	PL6057A122B	22	0.297	98.1	0.9	1.0	NAD	NAD
	Location: 2.7 Roof - Row 22: Black Vapor Barrier							
46	PL6057A123A	23	0.183	95.3	1.9	2.8	NAD	NAD
	Location: 3.1 Roof - Row 23: Black Vapor Barrier							
47	PL6057A123B	23	0.219	95.5	2.2	2.3	NAD	NAD
	Location: 3.1 Roof - Row 23: Black Vapor Barrier							
48	PL6057A124A	24	0.357	15.9	76.2	7.7	Chrysotile <0.25	Chrysotile <1.0
	Location: 2.1 Ext - Row 24: Off-White Residual Window Glazing							

See Reporting notes on last page

Client Name: Atlantic Testing Laboratories, Limited

Table I
Summary of Bulk Asbestos Analysis Results
 PL6057; Frontier Town Renovations; Schroon Lake, New York

AmeriSci Sample #	Client Sample#	HG Area	Sample Weight (gram)	Heat Sensitive Organic %	Acid Soluble Inorganic %	Insoluble Non-Asbestos Inorganic %	** Asbestos % by PLM/DS	** Asbestos % by TEM
49	PL6057AI24B	24	0.307	13.5	82.1	4.2	Chrysotile <1	Chrysotile <1.0
	Location: 2.1 Ext - Row 24: Off-White Residual Window Glazing							
50	PL6057AI25A	25	----	----	----	----	NAD	NA
	Location: 2.1 Bath - Row 25: White 2- By 4-Foot Paper Ceiling Tile							
51	PL6057AI25B	25	----	----	----	----	NAD	NA
	Location: 2.1 Bath - Row 25: White 2- By 4-Foot Paper Ceiling Tile							
52	PL6057AI26A	26	----	----	----	----	NAD	NA
	Location: 2.1 Bath - Row 26: White CWT Grout							
53	PL6057AI26B	26	----	----	----	----	NAD	NA
	Location: 2.1 Bath - Row 26: White CWT Grout							
54	PL6057AI27A	27	0.184	83.6	2.3	14.1	NAD	NAD
	Location: 2.1 Bath - Row 27: Yellow CWT Adhesive Row 26							
55	PL6057AI27B	27	0.113	81.2	2.2	16.6	NAD	NAD
	Location: 2.1 Bath - Row 27: Yellow CWT Adhesive Row 26							
56	PL6057AI28A	28	0.170	98.4	1.5	0.1	NAD	NAD
	Location: 2.1 Bath - Row 28: Off-White Textured Sheet Flooring							
57	PL6057AI28B	28	0.158	98.9	0.9	0.2	NAD	NAD
	Location: 2.1 Bath - Row 28: Off-White Textured Sheet Flooring							
58	PL6057AI29A	29	----	----	----	----	NAD	NA
	Location: 2.1 Siding - Row 29: Gray Wall Stucco							
59	PL6057AI29B	29	----	----	----	----	NAD	NA
	Location: 2.1 Siding - Row 29: Gray Wall Stucco							
60	PL6057AI30A	30	0.561	49.8	6.1	44.1	NAD	NAD
	Location: 2.1 Roof - Row 30: Gray Speckled Asphalt Shingle							
61	PL6057AI30B	30	0.506	48.7	5.3	46.0	NAD	NAD
	Location: 2.1 Roof - Row 30: Gray Speckled Asphalt Shingle							
62	PL6057AI31A	31	0.567	55.6	3.6	32.9	Chrysotile 7.7	NA
	Location: 2.1 Roof - Row 31: Black Paper Vapor Barrier Row 30							
63	PL6057AI31B	31	0.598	56.8	4.2	39.0	NA/PS	NA
	Location: 2.1 Roof - Row 31: Black Paper Vapor Barrier Row 30							

Client Name: Atlantic Testing Laboratories, Limited

Table I
Summary of Bulk Asbestos Analysis Results
 PL6057; Frontier Town Renovations; Schroon Lake, New York

AmeriSci Sample #	Client Sample#	HG Area	Sample Weight (gram)	Heat Sensitive Organic %	Acid Soluble Inorganic %	Insoluble Non-Asbestos Inorganic %	** Asbestos % by PLM/DS	** Asbestos % by TEM
-------------------	----------------	---------	----------------------	--------------------------	--------------------------	------------------------------------	-------------------------	----------------------

Analyzed by: Hongyan Ran
 Date: 2/6/2024



Reviewed by: Hongyan Ran



**Quantitative Analysis (Semi/Full); Bulk Asbestos Analysis - PLM by Appd E to Subpt E, 40 CFR 763 or NYSDOH ELAP 198.1 for New York friable samples or NYSDOH ELAP 198.6 for New York NOB samples; TEM (Semi/Full) by EPA 600/R-93/116 (or NYSDOH ELAP 198.4; for New York samples). Analysis using Hitachi, Model H7000-Noran 7 System, Microscope, Serial #: 747-05-06. NAD = no asbestos detected during a quantitative analysis; NA = not analyzed; Trace = < 1%; (SOF-V) = Sprayed On Fireproofing containing Vermiculite; (SM-V) = Surfacing Material containing Vermiculite; Quantitation for beginning weights of <0.1 grams should be considered as qualitative only; Qualitative Analysis: Asbestos analysis results of "Present" or "NVA = No Visible Asbestos" represents results for Qualitative PLM or TEM Analysis only (no accreditation coverage available from any regulatory agency for qualitative analyses): NVLAP (PLM) 200546-0, NYSDOH ELAP Lab 11480, NJ Lab ID #NY031.

Warning Note: PLM limitation, only TEM will resolve fibers <0.25 micrometers in diameter. TEM bulk analysis is representative of the fine grained matrix material and may not be representative of non-uniformly dispersed debris for which PLM evaluation is recommended (i.e. soils and other heterogenous materials).



ATLANTIC TESTING LABORATORIES ASBESTOS BULK SAMPLE CHAIN-OF-CUSTODY RECORD

Albany	22 Corporate Drive Clifton Park, NY 12065 518-383-9144 (T) 518-383-9166 (F) labsAT@atlantictesting.com	Binghamton	126 Park Avenue Binghamton, NY 13903 607-773-1812 (T) 607-773-1835 (F) labsET@atlantictesting.com	Canton	6431 U.S. Highway 11 Canton, NY 13617 315-386-4578 (T) 315-386-1012 (F) labsCT@atlantictesting.com	Plattsburgh	130 Arizona Ave Plattsburgh, NY 12903 518-563-5878 (T) 518-562-1321 (F) labsPL@atlantictesting.com	Poughkeepsie	251 Upper North Road Highland, NY 12528 845-691-6098 (T) 845-691-6099 (F) labsPT@atlantictesting.com	Rochester	3495 Winton Place Rochester, NY 14623 585-427-9020 (T) 585-427-9021 (F) labsRT@atlantictesting.com	Syracuse	6085 Court Street Road Syracuse, NY 13206 315-699-5281 (T) 315-699-3374 (F) labsST@atlantictesting.com	Utica	301 St. Anthony Street Utica NY 13501 315-735-3309 (T) 315-735-0742 (F) labsUT@atlantictesting.com	Watertown	26581 NYS Route 283 Watertown, NY 13601 315-786-7887 (T) 315-786-2022 (F) labsWT@atlantictesting.com
---------------	--------------------------------------------------------------------------------------------------------------------	-------------------	---------------------------------------------------------------------------------------------------------------	---------------	----------------------------------------------------------------------------------------------------------------	--------------------	----------------------------------------------------------------------------------------------------------------	---------------------	------------------------------------------------------------------------------------------------------------------	------------------	----------------------------------------------------------------------------------------------------------------	-----------------	--------------------------------------------------------------------------------------------------------------------	--------------	----------------------------------------------------------------------------------------------------------------	------------------	------------------------------------------------------------------------------------------------------------------

Project Number: PL6057	Project Name: Frontier Town Renovations	Project Location: Schroon Lake, New York	Page Number: 1 of 7
Project Manager: Robert Read	Email Results: <u>labspl</u> @atlantictesting.com		
Turn Around Time: <input type="checkbox"/> 12 hr <input type="checkbox"/> 24 hr <input type="checkbox"/> 48 hr <input type="checkbox"/> 72 hr <input checked="" type="checkbox"/> 5 day <input type="checkbox"/> Other:			

Date	Sample Number	Sample Location	Sample Description	PLM	PLM-NOB	TEM-NOB	Laboratory Sample ID Number
01/29/2024	PL6057A101A	Grist Mill	Row 1: Black Electrical Wire Jacket		X	X	
01/29/2024	PL6057A101B	Grist Mill	Row 1: Black Electrical Wire Jacket		X	X	
01/29/2024	PL6057A102A	Grist Mill Roof	Row 2: Black Paper Vapor Barrier		X	X	
01/29/2024	PL6057A102B	Grist Mill Roof	Row 2: Black Paper Vapor Barrier		X	X	
01/29/2024	PL6057A103A	Grist Mill Foundation	Row 3: Gray Mortar	X			
01/29/2024	PL6057A103B	Grist Mill Foundation	Row 3: Gray Mortar	X			
01/29/2024	PL6057A104A	Mill Chute	Row 4: Black Tar		X	X	
01/29/2024	PL6057A104B	Mill Chute	Row 4: Black Tar		X	X	
01/29/2024	PL6057A105A	2.1 Interior	Row 5: Tan Electrical Wire Jacket	X			
01/29/2024	PL6057A105B	2.1 Interior	Row 5: Tan Electrical Wire Jacket	X			

Special Instructions: <input checked="" type="checkbox"/> Positive Stop Analysis <input type="checkbox"/> If negative by PLM-NOB, analyze by TEM-NOB <input type="checkbox"/> Other:	
Laboratory: Field and Laboratory Remarks:	
Name: <u>Robert Read</u>	Date: <u>1/29/2024</u>
Signature: <u>[Signature]</u>	Time: <u>1500</u>
Samples Relinquished By:	
Name: <u>Robert Read</u>	Date: <u>1/30/2024</u>
Signature: <u>[Signature]</u>	Time: <u>1700</u>
Name: _____	Date: _____
Signature: _____	Time: _____
Samples Received By:	
Name: <u>Via FedEx</u>	Date: <u>2/2/24</u>
Signature: <u>[Signature]</u>	Time: <u>11:25</u>

224021210



ATLANTIC TESTING LABORATORIES ASBESTOS BULK SAMPLE CHAIN-OF-CUSTODY RECORD

Albany	22 Corporate Drive Clifton Park, NY 12065 518-383-9144 (T) 518-383-9166 (F)	Binghamton	126 Park Avenue Binghamton, NY 13903 607-773-1812 (T) 607-773-1835 (F)	Canton	6431 U.S. Highway 11 Canton, NY 13617 315-386-4578 (T) 315-386-1012 (F)	Plattsburgh	130 Arizona Ave Plattsburgh, NY 12903 518-563-5878 (T) 518-562-1321 (F)	Poughkeepsie	251 Upper North Road Highland, NY 12528 845-691-6098 (T) 845-691-6099 (F)	Rochester	3495 Winton Place Rochester, NY 14623 585-427-9020 (T) 585-427-9021 (F)	Syracuse	6085 Court Street Road Syracuse, NY 13206 315-699-5281 (T) 315-699-3374 (F)	Utica	301 St. Anthony Street Utica NY 13501 315-735-3309 (T) 315-735-0742 (F)	Watertown	26581 NYS Route 283 Watertown, NY 13601 315-786-7887 (T) 315-786-2022 (F)
---------------	--------------------------------------------------------------------------------------	-------------------	---------------------------------------------------------------------------------	---------------	----------------------------------------------------------------------------------	--------------------	----------------------------------------------------------------------------------	---------------------	------------------------------------------------------------------------------------	------------------	----------------------------------------------------------------------------------	-----------------	--------------------------------------------------------------------------------------	--------------	----------------------------------------------------------------------------------	------------------	------------------------------------------------------------------------------------

Project Number: PL6057	Project Name: Frontier Town Renovations	Project Location: Schroon Lake, New York
Project Manager: Robert Read	Email Results: <u>labsPL</u> @atlantictesting.com	Page Number: 2 of 7
Turn Around Time: <input type="checkbox"/> 12 hr <input type="checkbox"/> 24 hr <input type="checkbox"/> 48 hr <input type="checkbox"/> 72 hr <input checked="" type="checkbox"/> 5 day <input type="checkbox"/> Other:		

Special Instructions:		Sample Description	
<input checked="" type="checkbox"/> Positive Stop Analysis		<input checked="" type="checkbox"/> If negative by PLM-NOB, analyze by TEM-NOB	
Date	Sample Number	Sample Location	Sample Description
01/29/2024	PL6057AI06A	2.1 Collapsed	Row 6: Black Rolled Roofing
01/29/2024	PL6057AI06B	2.1 Collapsed	Row 6: Black Rolled Roofing
01/29/2024	PL6057AI07A	2.1 Int	Row 7: Off-White Sink Coating
01/29/2024	PL6057AI07B	2.1 Int	Row 7: Off-White Sink Coating
01/29/2024	PL6057AI08A	2.1 Int	Row 8: Tan Pattern Countertop
01/29/2024	PL6057AI08B	2.1 Int	Row 8: Tan Pattern Countertop
01/29/2024	PL6057AI09A	2.1 Int	Row 9: White Gypsum Board
01/29/2024	PL6057AI09B	2.1 Int	Row 9: White Gypsum Board
01/29/2024	PL6057AI10A	2.1 Int	Row 10: White Gypsum Board Associated White Joint Compound Row 9
01/29/2024	PL6057AI10B	2.1 Int	Row 10: White Gypsum Board Associated White Joint Compound Row 9

Sampler: <u>Read/Fessette</u>		Field and Laboratory Remarks:	
Name: <u>Robert Read</u>	Date: <u>1/29/2024</u>		
Signature: <u>[Signature]</u>	Time: <u>1500</u>		
Samples Relinquished By:			
Name: <u>Robert Read</u>	Date: <u>1/30/2024</u>		
Signature: <u>[Signature]</u>	Time: <u>1700</u>		
Samples Received By:			
Name: <u>Via FedEx</u>	Date: <u>-</u>		
Signature: <u>[Signature]</u>	Time: <u>-</u>		
Name: <u>Jadevetch</u>	Date: <u>2/6/24</u>		
Signature: <u>[Signature]</u>	Time: <u>11:25</u>		

224021210



ATLANTIC TESTING LABORATORIES ASBESTOS BULK SAMPLE CHAIN-OF-CUSTODY RECORD

Albany	22 Corporate Drive Clifton Park, NY 12065 518-383-9144 (T) 518-383-9166 (F)	Binghamton	126 Park Avenue Binghamton, NY 13903 607-773-1812 (T) 607-773-1835 (F)	Canton	6431 U.S. Highway 11 Canton, NY 13617 315-386-4578 (T) 315-386-1012 (F)	Plattsburgh	130 Arizona Ave Plattsburgh, NY 12903 518-563-5878 (T) 518-562-1321 (F)	Poughkeepsie	251 Upper North Road Highland, NY 12528 845-691-6098 (T) 845-691-6099 (F)	Rochester	3495 Winton Place Rochester, NY 14623 585-427-9020 (T) 585-427-9021 (F)	Syracuse	6085 Court Street Road Syracuse, NY 13206 315-699-5281 (T) 315-699-3374 (F)	Utica	301 St. Anthony Street Utica NY 13501 315-735-3309 (T) 315-735-0742 (F)	Watertown	26581 NYS Route 283 Watertown, NY 13601 315-786-7887 (T) 315-786-2022 (F)
---------------	--------------------------------------------------------------------------------------	-------------------	---------------------------------------------------------------------------------	---------------	----------------------------------------------------------------------------------	--------------------	----------------------------------------------------------------------------------	---------------------	------------------------------------------------------------------------------------	------------------	----------------------------------------------------------------------------------	-----------------	--------------------------------------------------------------------------------------	--------------	----------------------------------------------------------------------------------	------------------	------------------------------------------------------------------------------------

labsAT@atlantictesting.com labsET@atlantictesting.com labsCT@atlantictesting.com labsMT@atlantictesting.com labsPT@atlantictesting.com labsRT@atlantictesting.com labsST@atlantictesting.com labsTJ@atlantictesting.com labsWT@atlantictesting.com

Project Number: PL6057	Project Name: Frontier Town Renovations	Project Location: Schroon Lake, New York	Page Number: 3 of 7
Project Manager: Robert Read	Email Results: <u>labsPL</u> @atlantictesting.com	Turn Around Time: <input type="checkbox"/> 12 hr <input type="checkbox"/> 24 hr <input type="checkbox"/> 48 hr <input checked="" type="checkbox"/> 72 hr <input type="checkbox"/> Other:	

Special Instructions: Positive Stop Analysis If negative by PLM-NOB, analyze by TEM-NOB Other:

Date	Sample Number	Sample Location	Sample Description	PLM	PLM-NOB	TEM-NOB	Laboratory Sample ID Number
01/29/2024	PL6057AI10C	2.1 Int	Row 10: White Gypsum Board Associated White Joint Compound Row 9	X			
01/29/2024	PL6057AI11A	2.1 Int	Row 11: White Gypsum Ceiling Board Associated Tan Seam Tape Row 9	X			
01/29/2024	PL6057AI11B	2.1 Int	Row 11: White Gypsum Ceiling Board Associated Tan Seam Tape Row 9	X			
01/29/2024	PL6057AI12A	2.1 Int	Row 12: Gray 9- by 9-Inch Floor Tile		X	X	
01/29/2024	PL6057AI12B	2.1 Int	Row 12: Gray 9- by 9-Inch Floor Tile		X	X	
01/29/2024	PL6057AI13A	2.1 Int	Row 13: Black Flooring Vapor Barrier Row 12		X	X	
01/29/2024	PL6057AI13B	2.1 Int	Row 13: Black Flooring Vapor Barrier Row 12		X	X	
1/29/2024	PL6057AI14A	2.6 Int	Row 14: Gray 12- by 12-Inch Pattern Floor Tile		X	X	
1/29/2024	PL6057AI14B	2.6 Int	Row 14: Gray 12- by 12-Inch Pattern Floor Tile		X	X	
1/29/2024	PL6057AI15A	2.6 Int	Row 15: Yellow Adhesive Associated with Row 14		X	X	

Sampler: Read / Fiske Laboratory: _____ Field and Laboratory Remarks: _____

Name: Robert Read Date: 1/29/2024 Name: _____ Date: _____
 Signature: RT Time: 1500 Signature: _____ Time: _____

Samples Relinquished By: _____ Samples Received By: _____
 Name: Robert Read Date: 1/30/2024 Name: Via FedEx Date: _____
 Signature: RT Time: 1700 Signature: _____ Time: _____

Name: _____ Date: _____ Name: S. Nerglich Date: 2/2/24
 Signature: _____ Time: _____ Signature: SN Time: 11:25

224021210



ATLANTIC TESTING LABORATORIES ASBESTOS BULK SAMPLE CHAIN-OF-CUSTODY RECORD

Albany	22 Corporate Drive Clifton Park, NY 12065 518-383-9144 (T) 518-383-9166 (F)	Binghamton	126 Park Avenue Binghamton, NY 13903 607-773-1812 (T) 607-773-1835 (F)	Canton	6431 U.S. Highway 11 Canton, NY 13617 315-386-4578 (T) 315-386-1012 (F)	Plattsburgh	130 Arizona Ave Plattsburgh, NY 12903 518-563-5878 (T) 518-562-1321 (F)	Poughkeepsie	251 Upper North Road Highland, NY 12528 845-691-6098 (T) 845-691-6099 (F)	Rochester	3495 Winton Place Rochester, NY 14623 585-427-9020 (T) 585-427-9021 (F)	Syracuse	6085 Court Street Road Syracuse, NY 13206 315-699-5281 (T) 315-699-3374 (F)	Utica	301 St. Anthony Street Utica, NY 13501 315-735-3309 (T) 315-735-0742 (F)	Watertown	26581 NYS Route 283 Watertown, NY 13601 315-786-7887 (T) 315-786-2022 (F)
---------------	--------------------------------------------------------------------------------------	-------------------	---------------------------------------------------------------------------------	---------------	----------------------------------------------------------------------------------	--------------------	----------------------------------------------------------------------------------	---------------------	------------------------------------------------------------------------------------	------------------	----------------------------------------------------------------------------------	-----------------	--------------------------------------------------------------------------------------	--------------	-----------------------------------------------------------------------------------	------------------	------------------------------------------------------------------------------------

labsAT@atlantictesting.com labsET@atlantictesting.com labsCT@atlantictesting.com labsPL@atlantictesting.com labsPT@atlantictesting.com labsRT@atlantictesting.com labsST@atlantictesting.com labsUT@atlantictesting.com labsWT@atlantictesting.com

Project Number: PL6057		Project Name: Frontier Town Renovations		Project Location: Schroon Lake, New York			
Project Manager: Robert Read		Email Results: <i>labsPL</i> @atlantictesting.com		Page Number: 4 of 7			
Turn Around Time:	<input type="checkbox"/> 12 hr	<input type="checkbox"/> 24 hr	<input type="checkbox"/> 48 hr	<input checked="" type="checkbox"/> 72 hr	<input type="checkbox"/> 5 day		
Special Instructions:	<input checked="" type="checkbox"/> Positive Stop Analysis <input type="checkbox"/> If negative by PLM-NOB, analyze by TEM-NOB <input type="checkbox"/> Other:						
Date	Sample Number	Sample Location	Sample Description	PLM	PLM-NOB	TEM-NOB	Laboratory Sample ID Number
<i>1/28/2024</i>	PL6057AI15B	<i>2.6 Interior</i>	Row 15: Yellow Adhesive Associated with Row 14		X	X	
<i>1/28/2024</i>	PL6057AI16A	<i>2.6 Interior</i>	Row 16: Tan 12- by 12-Inch Pattern Linoleum		X	X	
<i>1/28/2024</i>	PL6057AI16B	<i>2.6 Interior</i>	Row 16: Tan 12- by 12-Inch Pattern Linoleum		X	X	
<i>1/28/2024</i>	PL6057AI17A	<i>2.6 Interior</i>	Row 17: Black Sink Coating		X	X	
<i>1/28/2024</i>	PL6057AI17B	<i>2.6 Interior</i>	Row 17: Black Sink Coating		X	X	
<i>1/28/2024</i>	PL6057AI18A	<i>2.6 Interior</i>	Row 18: Tan Pattern Countertop		X	X	
<i>1/28/2024</i>	PL6057AI18B	<i>2.6 Interior</i>	Row 18: Tan Pattern Countertop		X	X	
<i>1/28/2024</i>	PL6057AI19A	<i>2.6 Interior</i>	Row 19: White Fixture Caulk		X	X	
<i>1/28/2024</i>	PL6057AI19B	<i>2.6 Interior</i>	Row 19: White Fixture Caulk		X	X	
<i>1/28/2024</i>	PL6057AI20A	<i>2.6 Roof</i>	Row 20: Brown Asphalt Shingle		X	X	
Sampler: <i>Robert Read</i>							
Name: <i>Robert Read</i>		Date: <i>1/28/2024</i>		Field and Laboratory Remarks:			
Signature: <i>[Signature]</i>		Time: <i>1500</i>					
Samples Relinquished By:							
Name: <i>Robert Read</i>		Date: <i>1/30/2024</i>					
Signature: <i>[Signature]</i>		Time: <i>1700</i>					
Name:		Date:					
Signature:		Time:					

224021210



ATLANTIC TESTING LABORATORIES ASBESTOS BULK SAMPLE CHAIN-OF-CUSTODY RECORD

Albany 22 Corporate Drive Clifton Park, NY 12065 518-383-9144 (T) 518-383-9166 (F) labsAT@atlantictesting.com	Binghamton 126 Park Avenue Binghamton, NY 13903 607-773-1812 (T) 607-773-1835 (F) labsET@atlantictesting.com	Canton 6431 U.S. Highway 11 Canton, NY 13617 315-386-4578 (T) 315-386-1012 (F) labsCT@atlantictesting.com	Plattsburgh 130 Arizona Ave Plattsburgh, NY 12903 518-563-5878 (T) 518-562-1321 (F) labsPL@atlantictesting.com	Poughkeepsie 251 Upper North Road Highland, NY 12528 845-691-6098 (T) 845-691-6099 (F) labsPT@atlantictesting.com	Rochester 3495 Winton Place Rochester, NY 14623 585-427-9020 (T) 585-427-9021 (F) labsRT@atlantictesting.com	Syracuse 6085 Court Street Road Syracuse, NY 13206 315-699-5281 (T) 315-699-3374 (F) labsST@atlantictesting.com	Utica 301 St. Anthony Street Utica NY 13501 315-735-3309 (T) 315-735-0742 (F) labsUT@atlantictesting.com	Watertown 26581 NYS Route 283 Watertown, NY 13601 315-786-7887 (T) 315-786-2022 (F) labsWT@atlantictesting.com
-------------------------------------------------------------------------------------------------------------------------------------	------------------------------------------------------------------------------------------------------------------------------------	---------------------------------------------------------------------------------------------------------------------------------	--------------------------------------------------------------------------------------------------------------------------------------	-----------------------------------------------------------------------------------------------------------------------------------------	------------------------------------------------------------------------------------------------------------------------------------	---------------------------------------------------------------------------------------------------------------------------------------	--------------------------------------------------------------------------------------------------------------------------------	--------------------------------------------------------------------------------------------------------------------------------------

Project Number: **PL6057** Project Name: **Frontier Town Renovations** Project Location: **Schroon Lake, New York**

Project Manager: **Robert Read** Email Results: **labsPL @atlantictesting.com** Page Number: **5 of 7**

Turn Around Time: 12 hr 24 hr 48 hr 72 hr 5 day Other: _____

Special Instructions: Positive Stop Analysis If negative by PLM-NOB, analyze by TEM-NOB Other: _____

Date	Sample Number	Sample Location	Sample Description	PLM	PLM-NOB	TEM-NOB	Laboratory Sample ID Number
1/24/2024	PL6057AI20B	2.6 Roof	Row 20: Brown Asphalt Shingle		X	X	
1/24/2024	PL6057AI21A	2.6 Roof	Row 21: Black Vapor Barrier Row 20		X	X	
1/24/2024	PL6057AI21B	2.6 Roof	Row 21: Black Vapor Barrier Row 20		X	X	
1/24/2024	PL6057AI22A	2.7 Roof	Row 22: Black Vapor Barrier		X	X	
1/24/2024	PL6057AI22B	2.7 Roof	Row 22: Black Vapor Barrier		X	X	
1/24/2024	PL6057AI23A	3.1 Roof	Row 23: Black Vapor Barrier		X	X	
1/24/2024	PL6057AI23B	3.1 Roof	Row 23: Black Vapor Barrier		X	X	
01/29/2024	PL6057AI24A	2.1 Ext	Row 24: Off-White Residual Window Glazing	X			
01/29/2024	PL6057AI24B	2.1 Ext	Row 24: Off-White Residual Window Glazing	X			
01/29/2024	PL6057AI25A	2.1 Bath	Row 25: White 2- by 4-Foot Paper Ceiling Tile	X			

Sampler: **Read, Frisette** Laboratory: _____

Name: **Robert Read** Date: **1/24/2024** Name: _____ Date: _____
 Signature: **RA** Time: **1500** Signature: _____ Time: _____

Samples Relinquished By: _____
 Name: **Robert Read** Date: **1/30/2024** Name: _____ Date: _____
 Signature: **RA** Time: **1700** Signature: _____ Time: _____

Name: _____ Date: _____ Name: **J. Mervisch** Date: **2/2/24**
 Signature: _____ Time: _____ Signature: **[Signature]** Time: **11:05**

Field and Laboratory Remarks:

224021210



ATLANTIC TESTING LABORATORIES ASBESTOS BULK SAMPLE CHAIN-OF-CUSTODY RECORD

Albany	22 Corporate Drive Clifton Park, NY 12065 518-383-9144 (T) 518-383-9166 (F)	Binghamton	126 Park Avenue Binghamton, NY 13903 607-773-1812 (T) 607-773-1835 (F)	Canton	6431 U.S. Highway 11 Canton, NY 13617 315-386-4578 (T) 315-386-1012 (F)	Plattsburgh	130 Arizona Ave Plattsburgh, NY 12903 518-563-5878 (T) 518-562-1321 (F)	Poughkeepsie	251 Upper North Road Highland, NY 12528 845-691-6098 (T) 845-691-6099 (F)	Rochester	3495 Winton Place Rochester, NY 14623 585-427-9020 (T) 585-427-9021 (F)	Syracuse	6085 Court Street Road Syracuse, NY 13206 315-699-5281 (T) 315-699-3374 (F)	Utica	301 St. Anthony Street Utica, NY 13501 315-735-3309 (T) 315-735-0742 (F)	Watertown	26581 NYS Route 283 Watertown, NY 13601 315-786-7887 (T) 315-786-2022 (F)
---------------	--------------------------------------------------------------------------------------	-------------------	---------------------------------------------------------------------------------	---------------	----------------------------------------------------------------------------------	--------------------	----------------------------------------------------------------------------------	---------------------	------------------------------------------------------------------------------------	------------------	----------------------------------------------------------------------------------	-----------------	--------------------------------------------------------------------------------------	--------------	-----------------------------------------------------------------------------------	------------------	------------------------------------------------------------------------------------

labsAT@atlantictesting.com labsET@atlantictesting.com labsCT@atlantictesting.com labsPL@atlantictesting.com labsPT@atlantictesting.com labsRT@atlantictesting.com labsST@atlantictesting.com labsUT@atlantictesting.com labsWT@atlantictesting.com

Project Number: PL6057	Project Name: Frontier Town Renovations	Project Location: Schroon Lake, New York																																	
Project Manager: Robert Read	Email Results: labsPL @atlantictesting.com	Page Number: 6 of 7																																	
Turn Around Time: <input type="checkbox"/> 12 hr <input type="checkbox"/> 24 hr <input type="checkbox"/> 48 hr <input checked="" type="checkbox"/> 72 hr <input type="checkbox"/> Other:																																			
Special Instructions: <input checked="" type="checkbox"/> Positive Stop Analysis <input type="checkbox"/> If negative by PLM-NOB, analyze by TEM-NOB <input type="checkbox"/> Other:																																			
Date	Sample Number	Sample Location	Sample Description	PLM	PLM-NOB	TEM-NOB	Laboratory Sample ID Number																												
01/29/2024	PL6057/AI25B	2.1 Bath	Row 25: White 2- by 4-Foot Paper Ceiling Tile	X																															
01/29/2024	PL6057/AI26A	2.1 Bath	Row 26: White CWT Grout	X																															
01/29/2024	PL6057/AI26B	2.1 Bath	Row 26: White CWT Grout	X																															
1/29/2024	PL6057/AI27A	2.1 Bath	Row 27: Yellow CWT Adhesive Row 26		X	X																													
1/29/2024	PL6057/AI27B	2.1 Bath	Row 27: Yellow CWT Adhesive Row 26		X	X																													
01/29/2024	PL6057/AI28A	2.1 Bath	Row 28: Off-White Textured Sheet Flooring		X	X																													
01/29/2024	PL6057/AI28B	2.1 Bath	Row 28: Off-White Textured Sheet Flooring		X	X																													
01/29/2024	PL6057/AI29A	2.1 Siding	Row 29: Gray Wall Stucco		X																														
01/29/2024	PL6057/AI29B	2.1 Siding	Row 29: Gray Wall Stucco		X																														
01/29/2024	PL6057/AI30A	2.1 Roof	Row 30: Gray Speckled Asphalt Shingle		X	X																													
Sampler: <i>Robert Read / Fessette</i>																																			
Name: Robert Read		Date: 1/29/2024																																	
Signature: <i>Robert Read</i>		Time: 1500																																	
Samples Relinquished By:																																			
Name: Robert Read		Date: 1/30/2024																																	
Signature: <i>Robert Read</i>		Time: 1700																																	
Name:		Date:																																	
Signature:		Time:																																	
Field and Laboratory Remarks:																																			
<table border="0" style="width: 100%;"> <tr> <td style="width: 25%;">Name:</td> <td style="width: 25%;">Date:</td> <td style="width: 25%;">Time:</td> <td style="width: 25%;"></td> </tr> <tr> <td>Signature:</td> <td></td> <td></td> <td></td> </tr> <tr> <td colspan="4">Samples Received By:</td> </tr> <tr> <td>Name:</td> <td>Date:</td> <td>Time:</td> <td></td> </tr> <tr> <td>Signature: <i>Via FedEx</i></td> <td></td> <td></td> <td></td> </tr> <tr> <td>Name: <i>J. Magarich</i></td> <td>Date: <i>2/2/24</i></td> <td>Time:</td> <td></td> </tr> <tr> <td>Signature: <i>[Signature]</i></td> <td>Date: <i>11:25</i></td> <td>Time:</td> <td></td> </tr> </table>								Name:	Date:	Time:		Signature:				Samples Received By:				Name:	Date:	Time:		Signature: <i>Via FedEx</i>				Name: <i>J. Magarich</i>	Date: <i>2/2/24</i>	Time:		Signature: <i>[Signature]</i>	Date: <i>11:25</i>	Time:	
Name:	Date:	Time:																																	
Signature:																																			
Samples Received By:																																			
Name:	Date:	Time:																																	
Signature: <i>Via FedEx</i>																																			
Name: <i>J. Magarich</i>	Date: <i>2/2/24</i>	Time:																																	
Signature: <i>[Signature]</i>	Date: <i>11:25</i>	Time:																																	

224021210



ATLANTIC TESTING LABORATORIES ASBESTOS BULK SAMPLE CHAIN-OF-CUSTODY RECORD

Albany 22 Corporate Drive Clifton Park, NY 12065 518-383-9144 (T) 518-383-9166 (F) labsAT@atlantictesting.com	Binghamton 126 Park Avenue Binghamton, NY 13903 607-773-1812 (T) 607-773-1835 (F) labsBT@atlantictesting.com	Canton 6431 U.S. Highway 11 Canton, NY 13617 315-386-4578 (T) 315-386-1012 (F) labsCT@atlantictesting.com	Plattsburgh 130 Arizona Ave Plattsburgh, NY 12903 518-563-5878 (T) 518-562-1321 (F) labsPL@atlantictesting.com	Poughkeepsie 251 Upper North Road Highland, NY 12528 845-691-6098 (T) 845-691-6099 (F) labsPT@atlantictesting.com	Rochester 3495 Winton Place Rochester, NY 14623 585-427-9020 (T) 585-427-9021 (F) labsRT@atlantictesting.com	Syracuse 6085 Court Street Road Syracuse, NY 13206 315-699-5281 (T) 315-699-3374 (F) labsST@atlantictesting.com	Utica 301 St. Anthony Street Utica, NY 13501 315-735-3309 (T) 315-735-0742 (F) labsUT@atlantictesting.com	Watertown 26581 NYS Route 283 Watertown, NY 13601 315-786-7887 (T) 315-786-2022 (F) labsWT@atlantictesting.com
-------------------------------------------------------------------------------------------------------------------------------------	------------------------------------------------------------------------------------------------------------------------------------	---------------------------------------------------------------------------------------------------------------------------------	--------------------------------------------------------------------------------------------------------------------------------------	-----------------------------------------------------------------------------------------------------------------------------------------	------------------------------------------------------------------------------------------------------------------------------------	---------------------------------------------------------------------------------------------------------------------------------------	---------------------------------------------------------------------------------------------------------------------------------	--------------------------------------------------------------------------------------------------------------------------------------

Project Number: PL6057	Project Name: Frontier Town Renovations	Project Location: Schroon Lake, New York	Page Number: 7 of 7
Project Manager: Robert Read	Email Results: <u>labsPL</u> @atlantictesting.com		
Turn Around Time: <input type="checkbox"/> 12 hr <input type="checkbox"/> 24 hr <input type="checkbox"/> 48 hr <input type="checkbox"/> 72 hr <input checked="" type="checkbox"/> 5 day <input type="checkbox"/> Other:	Special Instructions: <input checked="" type="checkbox"/> Positive Stop Analysis <input type="checkbox"/> If negative by PLM-NOB, analyze by TEM-NOB <input type="checkbox"/> Other:		
Date	Sample Number	Sample Location	Sample Description
01/29/2024	PL6057AI30B	2.1 Roof	Row 30: Gray Speckled Asphalt Shingle
01/29/2024	PL6057AI31A	2.1 Roof	Row 31: Black Paper Vapor Barrier Row 30
01/29/2024	PL6057AI31B	2.1 Roof	Row 31: Black Paper Vapor Barrier Row 30
Sampler: <u>Paul Fessette</u>			
Laboratory: <u>Field and Laboratory Remarks:</u>			
Name: <u>Robert Read</u>	Date: <u>1/29/2024</u>	Name:	Date:
Signature: <u>AR</u>	Time: <u>1500</u>	Signature:	Time:
Samples Relinquished By:			
Name: <u>Robert Read</u>	Date: <u>1/30/2024</u>	Name:	Date:
Signature: <u>AR</u>	Time: <u>1700</u>	Signature: <u>Via FedEx</u>	Time:
Name:	Date:	Name: <u>J. Mercatich</u>	Date: <u>2/2/24</u>
Signature:	Time:	Signature: <u>AR</u>	Time: <u>11:25</u>

224021210



AmeriSci New York

117 EAST 30TH ST.
NEW YORK, NY 10016
TEL: (212) 679-8600 • FAX: (212) 679-3114

PLM Bulk Asbestos Report

Atlantic Testing Laboratories, Limited
Attn: Art Cross
6431 US Highway 11

Canton, NY 13617

Date Received 03/06/24 **AmeriSci Job #** 224031405
Date Examined 03/07/24 **P.O. #** 23414
ELAP # 11480 **Page** 1 of 1
RE: PL6057; Frontier Town Renovations; Schroon Lake, NY

Client No. / HGA	Lab No.	Asbestos Present	Total % Asbestos
PL6057AI29C	224031405-01	No	NAD
Location: 2" Siding - Row 29: Gray Wall Stucco			(by NYS ELAP 198.1) by Kensen Caro on 03/07/24
Analyst Description: Gray, Homogeneous, Non-Fibrous, Cementitious, Bulk Material			
Asbestos Types:			
Other Material: Non-fibrous 100%			

Reporting Notes:

Analyzed by: Kensen Caro
Date: 3/7/2024

Reviewed by: Kensen Caro

*NAD/NSD =no asbestos detected; NA =not analyzed; NA/PS=not analyzed/positive stop, (SOF-V) = Sprayed On Fireproofing containing Vermiculite; (SM-V) = Surfacing Material containing Vermiculite; PLM Bulk Asbestos Analysis using Olympus, Model BH-2 Pol Scope, Microscope, Serial #: 229003, by Appd E to Subpt E, 40 CFR 763 quantified by either CVES or 400 pt ct as noted for each analysis (NVLAP 200546-0), ELAP PLM Method 198.1 for NY friable samples, which includes the identification and quantitation of vermiculite, or ELAP 198.6 for NOB samples, or EPA 400 pt ct by EPA 600-M4-82-020 (NY ELAP Lab 11480); Note:PLM is not consistently reliable in detecting asbestos in floor coverings and similar non-friable organically bound materials. NAD or Trace results by PLM are inconclusive, TEM is currently the only method that can be used to determine if this material can be considered or treated as non asbestos-containing in NY State (also see EPA Advisory for floor tile, FR 59,146,38970,8/1/94) National Institute of Standards and Technology Accreditation requirements mandate that this report must not be reproduced except in full without the approval of the lab.This PLM report relates ONLY to the items tested. RI Cert AAL-094, CT Cert PH-0186, Mass Cert AA000054, NJ Lab ID #NY031.



ATLANTIC TESTING LABORATORIES

ASBESTOS BULK SAMPLE CHAIN-OF-CUSTODY RECORD

No. 23414

- Albany**
22 Corporate Drive
Clifton Park, NY 12065
518/383-9144 (T)
518/383-9166 (F)
labsAT@atlantictesting.com
- Binghamton**
126 Park Avenue
Binghamton, NY 13903
607/773-1812 (T)
607/773-1835 (F)
labsBT@atlantictesting.com
- Canton**
6431 U.S. Highway 11
Canton, NY 13617
315/886-4578 (T)
315/886-1012 (F)
labsCT@atlantictesting.com
- Elmira**
2330 Route 352
Elmira, NY 14903
607/737-0700 (T)
607/737-0714 (F)
labsET@atlantictesting.com
- Plattsburgh**
130 Arizona Ave
Plattsburgh, NY 12903
518/563-5878 (T)
518/562-1321 (F)
labsPL@atlantictesting.com
- Poughkeepsie**
251 Upper North Road
Highland, NY 12528
845/691-6098 (T)
845/691-6099 (F)
labsPT@atlantictesting.com
- Rochester**
3495 Winton Place
Rochester, NY 14623
585/427-9020 (T)
585/427-9021 (F)
labsRT@atlantictesting.com
- Syracuse**
6085 Court Street Road
Syracuse, NY 13206
315/699-5281 (T)
315/699-3374 (F)
labsST@atlantictesting.com
- Utica**
301 St. Anthony Street
Utica, NY 13501
315/735-3309 (T)
315/735-0742 (F)
labsUT@atlantictesting.com
- Watertown**
26581 NYS Route 283
Watertown, NY 13601
315/786-7887 (T)
315/786-2022 (F)
labsWT@atlantictesting.com

Project No. PL 6057	Project Name Frontier Town Renovations	Date Collected 03/05/2024	Laboratory Instructions <input type="checkbox"/> 12hr <input checked="" type="checkbox"/> 24hr <input type="checkbox"/> 48hr <input type="checkbox"/> 72hr <input type="checkbox"/> 5day <input type="checkbox"/> Positive Stop Analysis <input type="checkbox"/> If negative by PLM-NOB, analyze by TEM-NOB <input type="checkbox"/> Other		Send Reports To (ATL Office): Plattsburgh	Report Distribution Art Cross
Project Contact: Robert Reed	Project Location: Schroon Lake NY	Page 1 of 1	Turn-Around-Time:	Special Instructions:	Send Copy To:	email Results: PL9ab5 @atlantictesting.com
Field Sample No. PL6057A129C	Sample Location 2.1 Siding	Sample Description Row 29: Gray Wall Stucco		Analysis Requested PLM <input checked="" type="checkbox"/> TEM-NOB <input type="checkbox"/> MICRO-VAC <input type="checkbox"/>	Laboratory Sample ID No.	
Sampler's Name: Arthur Cross	Date: 03/05/24	Received at Laboratory (Name): Alexacam		Date: 3/6/24	Shipment Rec'd Intact <input type="checkbox"/> YES <input type="checkbox"/> NO	
Sampler's Signature: <i>[Signature]</i>	Time: 7:35	Laboratory Signature: <i>[Signature]</i>		Time: 11:16		
Samples Relinquished By: TJ Ferry		Samples Received By:		Field and Laboratory Remarks:		
Name: Terry Ferris	Date: 3/5	Name:	Date:			
Signature: <i>[Signature]</i>	Time: 10:13	Signature:	Time:			
Name:	Date:	Name:	Date:			
Signature:	Time:	Signature:	Time:			

Think Quality

APPENDIX D
SUMMARY TABLES

KEY FOR SUMMARY TABLES

Acronyms for the Known or Assumed ACM:

CFT = Ceramic Floor Tile

CWT = Ceramic Wall Tile

EPDM = Ethylene Propylene Diene Monomer

HVAC = Heating, Ventilation, and Air Conditioning

TSI = Thermal System Insulation

Abbreviations for Friable/ACM Type:

Y = Yes

N = No

M = Miscellaneous

S = Surfacing

T = Thermal System Insulation

Descriptions for Conditions:

The listed conditions of Good, Fair, and Poor generally correspond with the AHERA descriptions of Good, Damaged, and Significantly Damaged for different types of materials. The following summarizes additional details relative to the listed conditions.

Surfacing (Surf.) and Miscellaneous (Misc.) Materials

- Good: Material with no visible damage or deterioration, or showing only very limited damage or deterioration
- Fair: Material with characteristics of surface crumbling, blistered, water-stained, gouged, marred, or otherwise abraded over less than one tenth of the surface if the damage is evenly distributed or one quarter if the damage is localized.
- Poor: Material with one or more of the following characteristics:
 - Surface crumbling or blistering is present over at least one tenth of the surface, if the damage is evenly distributed or one quarter if the damage is localized.
 - One tenth (or one quarter, if localized) of material hanging from the surface, deteriorated, or showing adhesive failure.
 - Water stains, gouges, or mars over at least one tenth of the surface if the damage is evenly distributed or one quarter if the damage is localized.

Thermal System Insulation (TSI) Materials

- Good: Material with no visible damage or deterioration, or showing only very limited damage or deterioration
- Fair: Material with one or more of the following characteristics:
 - A few water stains or less than one tenth of insulation with missing jackets.
 - Crushed insulation or water stains, gouges, punctures, or mars on up to one tenth of the insulation if the damage is evenly distributed or up to one quarter if the damage is localized.
- Poor: Material with one or more of the following characteristics:
 - Missing jackets on at least one tenth of the piping or equipment.
 - Crushed or heavily gouged or punctured insulation on at least one tenth of the component (pipe runs/risers, boiler, tank, duct, etc.) if the damage is evenly distributed or one quarter if the damage is localized.

Notes:

¹ Sample Location Plans are enclosed in Appendix B.

^{2a} NAD = No Asbestos Detected/ ^{2b} ND = Not detected above the laboratory method detection limit.

³ Quantities and locations are approximate and must be verified by asbestos abatement contractors prior to providing actual cost quotations and/or initiating abatement activities.

⁴ NA = Not Applicable

⁵ Material was determined to be an incidental disturbance and will need to have an incidental disturbance assessment performed prior to any abatement and/or renovation activities.

⁶ Material assumed asbestos containing (ACM) based on inaccessibility.

Table D-I
Summary of Suspect ACM and Analytical Results

Material	General Location ¹	Friable /ACM Type	% Asbestos ^{2A}	Condition	Sample Numbers	Estimated Quantity ^{3, 4}
Grist Mill – Building 5.2						
Black Electrical Wire Jacket	Interior	N / M	NAD	Poor	PL6057AI01A PL6057AI01B	NA
Black Paper Vapor Barrier	Roof (Under Wood)	N / M	NAD	Fair	PL6057AI02A PL6057AI02B	NA
Gray Mortar	Foundation	N / M	NAD	Fair	PL6057AI03A PL6057AI03B	NA
Black Tar	Water Chute	N / M	9.2	Fair	PL6057AI04A PL6057AI04B	100 Square Feet
Building 2.1						
Tan Electrical Wire Jacket	Interior	N / M	NAD	Poor	PL6057AI05A PL6057AI05B	NA
Black Rolled Roofing	Collapsed Section	N / M	NAD	Fair	PL6057AI06A PL6057AI06B	NA
Off-White Sink Coating	Interior	N / M	2.1	Good	PL6057AI07A PL6057AI07B	12 Square Feet
Tan Wood Pattern Countertop	Interior	N / M	NAD	Poor	PL6057AI08A PL6057AI08B	NA
White Gypsum Board	Interior	Y / M	NAD	Poor	PL6057AI09A PL6057AI09B	NA
White Gypsum Board Associated White Joint Compound	Interior	Y / M	NAD	Poor	PL6057AI10A PL6057AI10B PL6057AI10C	NA
White Gypsum Board Associated Tan Seam Tape	Interior	Y / M	NAD	Poor	PL6057AI11A PL6057AI11B	NA
Gray 9- by 9-Inch Floor Tile	Interior	N / M	1.7	Poor⁵	PL6057AI12A PL6057AI12B	96 Square Feet
Black Flooring Vapor Barrier	Interior	N / M	NAD	Poor	PL6057AI13A PL6057AI13B	NA
Off-White Residual Window Glazing	Exterior	N / M	Trace	Poor	PL6057AI24A PL6057AI24B	NA
White 2- by 4-Foot Paper Ceiling Tile on Yellow Fiberglass	Bathroom	N / M	NAD	Poor	PL6057AI25A PL6057AI25B	NA
White CWT Grout	Bathroom	N / M	NAD	Poor	PL6057AI26A PL6057AI26B	NA
Yellow CWT Adhesive	Bathroom	N / M	NAD	Fair	PL6057AI27A PL6057AI27B	NA
Off-White Textured Sheet Flooring	Bathroom	N / M	NAD	Poor	PL6057AI28A PL6057AI28B	NA
Gray Wall Stucco	Exterior	Y / S	NAD	Poor	PL6057AI29A PL6057AI29B PL6057AI29C	500 Square Feet
Gray Speckled Asphalt Shingle	Roof	N / M	NAD	Poor	PL6057AI30A PL6057AI30B	NA

Table D-I
Summary of Suspect ACM and Analytical Results

Material	General Location ¹	Friable /ACM Type	% Asbestos ^{2A}	Condition	Sample Numbers	Estimated Quantity ^{3, 4}
Black Paper Vapor Barrier	Roof	N / M	7.7	Poor ⁵	PL6057AI31A PL6057AI31B	3,000 Square Feet
Inaccessible Building Materials⁶	Collapsed Areas of Building⁶	NA	Assumed ⁶	Poor ^{5, 6}	PL6057AI32	1,500 Square Feet
Building 2.6						
Gray 12- by 12-Inch Pattern Floor Tile	Interior	Y / M	2.1	Poor	PL6057AI14A PL6057AI14B	80 Square Feet
Yellow Adhesive Associated with Gray 12- by 12-Inch Pattern	Interior	N / M	NAD	Poor	PL6057AI15A PL6057AI15B	NA
Tan 12- by 12-Inch Pattern Linoleum	Interior	N / M	NAD	Poor	PL6057AI16A PL6057AI16B	NA
Black Sink Coating	Interior	Y / M	8.3	Fair	PL6057AI17A PL6057AI17B	6 Square Feet
Tan Pattern Countertop	Interior	N / M	NAD	Poor	PL6057AI18A PL6057AI18B	NA
White Fixture Caulk	Interior	N / M	NAD	Poor	PL6057AI19A PL6057AI19B	NA
Brown Asphalt Shingle	Interior	N / M	NAD	Poor	PL6057AI20A PL6057AI20B	NA
Black Vapor Barrier	Interior	N / M	NAD	Poor	PL6057AI21A PL6057AI21B	NA
Building 2.7 - Carousel						
Black Vapor Barrier	Roof	N / M	NAD	Poor	PL6057AI22A PL6057AI22B	NA
Building 3.1 - Chapel						
Black Vapor Barrier	Roof	N / M	NAD	Poor	PL6057AI23A PL6057AI23B	NA

APPENDIX E

SUMMARY OF XRF RESULTS AND CALIBRATION CHECKS

Table E-I
Summary of XRF Test Results - Lead Detected at Greater than or Equal to 1 mg/cm²

Reading No	Date	Time	Structure	Member	Substrate	Side	Condition	Color	Room	Result (mg/cm ²)
PL6057LX58	1/31/2024	16:32:01	Room	Wall	Wood	A	Deteriorated	White	2.6 l	1
PL6057LX59	1/31/2024	16:32:30	Room	Wall	Wood	B	Deteriorated	White	2.6 l	1
PL6057LX62	1/31/2024	16:33:44	Room	Ceiling	Wood	D	Deteriorated	White	2.6 l	1.4
PL6057LX67	1/31/2024	16:37:32	Room	Wall	Wood	A	Deteriorated	Green	2.1 Exterior	3.5
PL6057LX68	1/31/2024	16:37:51	Room	Wall	Wood	A	Deteriorated	Green	2.1 Exterior	3
PL6057LX70	1/31/2024	16:39:07	Room	Wall	Wood	D	Deteriorated	Yellow	2.1	1
PL6057LX75	1/31/2024	16:43:41	Room	Wall	Wood	B	Deteriorated	Yellow	2.1 Exterior	1.8
PL6057LX85	1/31/2024	16:49:04	Door	Casing	Wood	C	Deteriorated	Red	2.1 Exterior	1.8
PL6057LX88	1/31/2024	16:51:45	Room	Wall	Wood	C	Deteriorated	Beige	2.1 Exterior	2.1
PL6057LX89	1/31/2024	16:52:18	Fascia	---	Wood	C	Deteriorated	Green	2.1 Exterior	1.5
PL6057LX90	1/31/2024	16:54:37	Room	Wall	Wood	C	Deteriorated	Yellow	2.1 Exterior	1
PL6057LX91	1/31/2024	16:55:12	Window	Casing	Wood	C	Deteriorated	Red	2.1 Exterior	1.3
PL6057LX93	1/31/2024	16:56:06	Column	---	Wood	C	Deteriorated	Yellow	2.1 Exterior	2.1
PL6057LX103	1/31/2024	17:01:24	Room	Wall	Ceramic	D	Intact	Light Blue	2.1 Bath	1.2

Notes:

Alpha numerical room side designations were based on A beginning with the address side of the building and progressing clockwise around the room.

Table E-II
Summary of XRF Test Results - Lead Detected at Less than 1 mg/cm²

Reading No	Date	Time	Structure	Member	Substrate	Side	Condition	Color	Room	Result (mg/cm ²)
PL6057LX40	1/31/2024	16:16:25	Room	Wall	Wood	C	Deteriorated	Red	5.2 Exterior wheel	0.2
PL6057LX42	1/31/2024	16:17:51	Window	Shutter	Wood	C	Deteriorated	Red	5.2 Exterior	0.2
PL6057LX43	1/31/2024	16:19:38	Railing	N/A	Wood	D	Deteriorated	Red	5.2 Exterior	0.1
PL6057LX44	1/31/2024	16:19:49	Railing	N/A	Wood	D	Deteriorated	Red	5.2 Exterior	0.1
PL6057LX45	1/31/2024	16:20:15	Railing	N/A	Wood	A	Deteriorated	Red	5.2 Exterior	0.2
PL6057LX46	1/31/2024	16:24:48	Column	---	Wood	D	Deteriorated	Red	2.7 Exterior	0.2
PL6057LX47	1/31/2024	16:25:13	Railing		Wood	D	Deteriorated	Red	2.7 Exterior	0.1
PL6057LX48	1/31/2024	16:25:34	Railing		Wood	D	Deteriorated	White	2.7 Exterior	0.1
PL6057LX51	1/31/2024	16:27:58	Window	Casing	Wood	B	Deteriorated	Light Blue	2.6 Exterior	0.1
PL6057LX52	1/31/2024	16:28:30	Porch	Ceiling	Wood	B	Deteriorated	White	2.6 Exterior	0.1
PL6057LX53	1/31/2024	16:28:58	Room	Wall	Wood	B	Deteriorated	Red	2.6 Exterior	0.1
PL6057LX54	1/31/2024	16:29:20	Room	Wall	Wood	C	Deteriorated	Red	2.6 Exterior	0.1
PL6057LX55	1/31/2024	16:30:10	Window	Casing	Wood	C	Deteriorated	Light Blue	2.6 Exterior	0.6
PL6057LX56	1/31/2024	16:30:34	Window	Casing	Wood	C	Deteriorated	Light Blue	2.6 Exterior	0.4
PL6057LX60	1/31/2024	16:32:57	Room	Wall	Wood	C	Deteriorated	White	2.6 l	0.8
PL6057LX61	1/31/2024	16:33:25	Room	Wall	Wood	D	Deteriorated	White	2.6 l	0.1
PL6057LX63	1/31/2024	16:35:53	Room	Wall	Wood	A	Deteriorated	Red	2.1 Exterior	0.1
PL6057LX64	1/31/2024	16:36:10	Room	Wall	Wood	A	Deteriorated	Red	2.1 Exterior	0.2
PL6057LX65	1/31/2024	16:36:32	Door	---	Wood	A	Deteriorated	Red	2.1 Exterior	0.2
PL6057LX69	1/31/2024	16:38:28	Room	Ceiling	Wood	Center	Deteriorated	White	2.1	0.1
PL6057LX71	1/31/2024	16:40:18	Room	Wall	Wood	D	Deteriorated	Brown	2.1	0.2
PL6057LX72	1/31/2024	16:41:40	Room	Ceiling	Metal	Center	Deteriorated	White	2.1	0.3
PL6057LX73	1/31/2024	16:42:26	Room	Wall	Gypsum	D	Deteriorated	Off-White	2.1	0.2
PL6057LX74	1/31/2024	16:42:52	Room	Wall	Wood	D	Deteriorated	Brown	2.1	0.1
PL6057LX76	1/31/2024	16:44:05	Door	Casing	Wood	B	Deteriorated	Red	2.1 Exterior	0.2
PL6057LX77	1/31/2024	16:44:35	Room	Wall	Wood	A	Deteriorated	Orange	2.1 Exterior	0.3
PL6057LX78	1/31/2024	16:45:16	Room	Wall	Gypsum	Center	Deteriorated	White	2.1	0.2
PL6057LX81	1/31/2024	16:46:53	Room	Wall	Wood	Center	Deteriorated	Red	2.1	0.1
PL6057LX82	1/31/2024	16:47:48	Room	Wall	Wood	C	Deteriorated	Green	2.1 Exterior	0.2
PL6057LX83	1/31/2024	16:48:01	Room	Wall	Wood	C	Deteriorated	Green	2.1 Exterior	0.3
PL6057LX84	1/31/2024	16:48:42	Room	Wall	Wood	C	Deteriorated	Red	2.1 Exterior	0.2
PL6057LX86	1/31/2024	16:49:45	Window	Casing	Wood	C	Deteriorated	Yellow	2.1 Exterior	0.3
PL6057LX87	1/31/2024	16:50:15	Porch	Ceiling	Wood	Center	Deteriorated	Red	2.1 Exterior	0.2
PL6057LX92	1/31/2024	16:55:45	Column	---	Wood	C	Deteriorated	Yellow	2.1 Exterior	0.4
PL6057LX94	1/31/2024	16:56:41	Room	Wall	Wood	C	Deteriorated	Red	2.1 Exterior	0.4

**Table E-II
Summary of XRF Test Results - Lead Detected at Less than 1 mg/cm²**

Reading No	Date	Time	Structure	Member	Substrate	Side	Condition	Color	Room	Result (mg/cm²)
PL6057LX95	1/31/2024	16:56:53	Room	Wall	Wood	C	Deteriorated	Red	2.1 Exterior	0.3
PL6057LX97	1/31/2024	16:57:46	Window	Casing	Wood	C	Deteriorated	Green	2.1 Exterior	0.2
PL6057LX98	1/31/2024	16:58:02	Window	Sill	Wood	C	Deteriorated	Green	2.1 Exterior	0.2
PL6057LX99	1/31/2024	16:58:50	Window	Casing	Wood	C	Deteriorated	Black	2.1 Exterior	0.1
PL6057LX100	1/31/2024	16:59:21	Room	Wall	Plaster	C	Deteriorated	White	2.1 Exterior	0.4
PL6057LX101	1/31/2024	17:00:18	Door	Casing	Wood	D	Deteriorated	White	2.1 Exterior	0.1
PL6057LX102	1/31/2024	17:00:31	Door	Casing	Wood	D	Deteriorated	White	2.1 Exterior	0.1

**Table E-III
Summary of XRF Test Results - No Lead Detected**

Reading No	Date	Time	Structure	Member	Substrate	Side	Condition	Color	Room	Result (mg/cm²)
PL6057LX41	1/31/2024	16:17:03	Room	Wall	Metal	C	Intact		5.2 Exterior chute	0
PL6057LX49	1/31/2024	16:26:27	Fascia		Wood	D	Deteriorated	White	2.7 Exterior	0
PL6057LX50	1/31/2024	16:27:33	Fascia		Wood	B	Deteriorated	Light Blue	2.6 Exterior	0
PL6057LX57	1/31/2024	16:31:24	Room	Wall	Wood	D	Deteriorated	Red	2.6 Exterior	0
PL6057LX66	1/31/2024	16:37:00	Door	Casing	Wood	A	Deteriorated	Yellow	2.1 Exterior	0
PL6057LX79	1/31/2024	16:45:39	Room	Ceiling	Gypsum	Center	Deteriorated	White	2.1	0
PL6057LX80	1/31/2024	16:46:18	Room	Ceiling	Metal	Center	Deteriorated	White	2.1	0
PL6057LX96	1/31/2024	16:57:20	Door	Casing	Wood	C	Deteriorated	Green	2.1 Exterior	0
PL6057LX104	1/31/2024	17:02:12	Room	Wall	Wood	Center	Intact	Light Blue	2.1 Bath	0

Table E-IV
Summary of XRF Calibration Results

Reading No	Date	Time	Structure	Member	Substrate	Side	Condition	Color	Room	Result (mg/cm²)
PL6057LX37	1/31/2024	16:12:23				Calibration				0.9
PL6057LX38	1/31/2024	16:12:42				Calibration				0.9
PL6057LX39	1/31/2024	16:13:08				Calibration				1
PL6057LX105	1/31/2024	17:05:45				Calibration				0.9
PL6057LX106	1/31/2024	17:06:05				Calibration				0.9
PL6057LX107	1/31/2024	17:06:25				Calibration				0.9